

2014 Catalog

EFFECTIVE JANUARY 1, 2014

*Application engineering required with each system.
Contact the Water Maze Factory or your local certified Water Maze dealer.*



Other outstanding systems from Water Maze:

ISO 9001 REGISTERED
PATENT PENDING



www.wmaze.com • 800-347-6116 • Fax 800-535-9164 • info@wmaze.com

NOTE: We are constantly improving and updating our products. Consequently, pictures, features and specifications in this brochure may differ slightly from current models. Flow rates and pressure ratings may vary due to variances allowed by manufacturers of our machine components, as well as contaminant loadings in the influent water.

INNOVATOR SERIES: INNOVATION IN WATER TREATMENT SOLUTIONS

The Innovator Series includes a variety of modular products and technologies designed to treat industrial waste water from a wide range of applications. Subject to the waste water characteristics and the application requirements, individual modules can be selected and incorporated into a complete solution.

These new products have been designed with input from various types of end-users. The products incorporate industrial grade components and features that make each component easy to understand, operate, and maintain. The applied water treatment technologies are robust and they are designed to treat applications with more complex waste water characteristics (i.e., suspended solids, emulsified oils & greases, and heavy metals). When correctly applied, the treated water quality should be cleaner and better than most other competing brands.

One of the key features & benefits of the Innovator Series is that water does not stand in the system for extended periods of time. The incorporated robust technologies allows for immediate processing with minimal dwell time. Therefore, water is processed and discharged, or pumped through the recycle module for reuse.



COAG2-20A: WATER TREATMENT SYSTEM



CoAg2-20A



A proprietary (patent pending) water treatment system that incorporates chemical coagulation and chemical flocculation technology. This system features industrial grade components and is simple to use and maintain, but is highly effective for treating a broad range of waste streams including suspended solids and emulsified oils. This system will automatically process water and move it downstream so that no standing water is retained within the system after processing is complete. Water is processed on a batch-feed, continual basis.

The equipment specifications include:

- skid mounted steel platform
- fully enclosed control cabinet with lockable front doors
- steel components are protected with 2-part zinc epoxy powder coat finish
- PLC (automated) control system
- Clean Water Top Purge System allows for decanting of clean water above sludge line in each tank
- ¾ hp infeed pump with flow switch shut-down system
- inline chemical injection with mixing chambers
- chemical containers include low level liquid sensors
- (2) two 150-gal. polyethylene cone-bottom mixing tanks with air-actuated directional control valves
- auto-purge valves for each tank

EC2-20A: ELECTRO-COAGULATION (EC+) WATER TREATMENT SYSTEM



EC2-20A



A proprietary (patent pending) water treatment system that incorporates a new generation of Electro-coagulation and chemical flocculation technology. This system features robust industrial grade components and is simple to use and maintain, but is highly effective for treating a broad range of waste streams including suspended solids, emulsified oils, and heavy metals. This system will automatically process water and move it downstream so that no standing water is retained within the system after processing is complete. Water is processed on a batch-feed, continual basis.

The equipment specifications include:

- skid mounted steel platform
- fully enclosed control cabinet with lockable front doors
- steel components are protected with 2-part zinc epoxy powder coat finish
- PLC (automated) control system
- ¾ hp infeed pump with flow switch shut-down system
- (1) One Electrolytic cell assembly
- automatic forward cell flush system
- post EC cell inline mixing chambers
- automatic chemical flocculant injection system
- chemical containers include low level liquid sensors
- (2) two 150-gal. polyethylene cone-bottom mixing tanks with air-actuated directional control valves
- auto-purge valves for each tank

IPF2-20D: INDEXING POLISHING FILTER

The IPF solids dewatering unit utilizes inexpensive fabric media to filter out solid particles. Fabric paper, which is supplied in 5, 20, and 50 micron sizes, is automatically indexed onto a recessed conveyor belt made of high tensile, non-metallic material. As water and solid particles drain through the fabric paper, solids are retained by the fabric paper. As the fabric paper blinds over, the water level will rise, a float will actuate a drive motor and gear system, the conveyor belt will index forward allowing the spent paper to fall into a collection container and new paper to index onto the conveyor belt. The IPF can be applied for pretreatment, post treatment, or as a stand alone treatment system.



IPF2-20D

The equipment specifications include:

- made of industrial grade components
- carbon steel exterior with a stainless steel interior that protects the wetted surfaces from rusting
- all carbon steel surfaces are protected with a two part Zinc Epoxy Powder Coat finish
- the load bearing side (top side) of conveyor belt is fully supported to eliminate belt sagging
- the drive motor is exterior mounted with a covered housing to protect it from moisture and it has an ETL / UL approved safety shut-off switch
- the paper roll enclosure includes an electronic sensor to signal "low paper" conditions to an external device (supplied by others)
- includes (4) four adjustable legs to change the elevation of the unit
- includes a collection container for spent paper and sludge
- NOTE: Fabric paper is not included, must be purchased separately



REC2-20A: RECYCLE WATER / RECIRCULATION MODULE

This product is a water management control center that receives processed water from another source. The unit includes: a pump to transfer pretreated water into a clean-water holding tank (tank supplied by others); a ¾ HP pump with mazzei injector to circulate water in the clean-water holding tank; a transfer pump with pressure tank and manifold piping system to transfer the clean water back to the point of use; an electrical control center; fresh water makeup and excess water discharge system with float controls.



REC2-20A

The equipment specifications include:

- skid-mounted enclosure made of carbon steel with lockable front door
- all steel components are protected with zinc epoxy powder coat finish
- the electrical center is housed in a Nema box
- includes a ¾ HP infeed pump to draw water into a clean water holding tank (tank not included)
- a 1 ½ HP transfer pump with pressurization system (bladder pressure tank, manifold, pressure switch, etc.)
- 3/4 HP circulation pump with mazzei injector and timer control (PLC)
- a hose connection manifold center
- fresh water make up and excess water discharge solenoids with float controls
- PLC (automated) control system

EQUIPMENT				
Model	Part Number	System Type (Technology)	Process Flow GPM	Volts/Phase Amps
CoAg2-20A	1.103-487.0	Chemical / Chemical	up to 20	230/1/6
EC2-20A	1.103-486.0	EC / Chemical	up to 10	230/1/44
IPF2-20D	1.103-488.0	Fabric Media Filter	up to 20	120/3
REC2-20A	1.103-489.0	Recycle Module	up to 20	230/1/22

OPTIONS, UPGRADES & ACCESSORIES	
Part #	Description
CoAg2-20A	
8.917-355.0	Stainless steel skid with Zinc epoxy powder coat finish
8.917-354.0	pH Control Kit: includes pH controller, peristaltic pump, inline mixing tubes (Factory Installed)
EC2-20A	
8.917-355.0	Stainless steel skid with Zinc epoxy powder coat finish
8.917-354.0	pH Control Kit: includes pH controller, peristaltic pump, inline mixing tubes (Factory Installed)
8.917-356.0	65-gallon clean water reservoir with fill kit (e.g., float valve, hose connection, bulkhead fitting) for EC cell flushing for discharge apps only
IPF2-20D	
8.917-279.0	Water retention container (approx. 40 gallon capacity)
REC2-20A	
8.917-652.0	Stainless steel skid with Zinc epoxy powder coat finish
8.917-651.0	UV Ozone generator (Series 400) with mounting bracket
ADD-ONS TO INNOVATOR SERIES	
1.103-467.0	PM-1000D BioSystem – bioremediation for dissolved organics
1.103-406.0	AMC-1000, Auto-purge Maintenance Control Retrofit Kit, 120V

PARTS & CONSUMABLES	
Part #	Description
8.725-445.0	CoAg+ Coagulant – 5 gallons
8.725-446.0	CoAg+ Coagulant – 55 gallons
8.940-586.0	EC+ Flocculant (Polymer) – 5 gallons
8.725-508.0	EC+ Flocculant (Polymer) – 55 gallons
8.750-280.0	Metal R+ Coagulant – 5 gallons
8.750-281.0	Metal R+ Coagulant – 55 gallons
8.749-550.0	Liquid Alum (Aluminum Sulfate) – 5 gallons (pH control)
8.749-549.0	Liquid Alum (Aluminum Sulfate) – 55 gallons (pH control)
8.752-171.0	Fabric Media, Filter – 50 micron x 1100 yards
8.752-173.0	Fabric Media, Filter – 20 micron x 650 yards
8.752-172.0	Fabric Media, Filter – 5 micron x 500 yards
9.807-472.0	Replacement Electrolytic cell (for EC2-20A)
8.716-143.0	Control float switch for infeed pump (EC2-20A, CoAg2-20A or REC2-20A)

Note: The actual consumption rates will vary based on the site specific waste water characteristics



COMPACT COAG: COST-EFFECTIVE WATER TREATMENT SYSTEM

The Compact CoAg unit employs chemical coagulation and flocculation water treatment technology to enhance and speed up the process of removing suspended solids and most types of emulsified oils. This product utilizes a patent pending process for applying and mixing proprietary blends of chemical coagulant (CoAg+) and flocculant (EC+) to effectively de-emulsify oils and to agglomerate suspended solids. The Compact CoAg unit is typically combined with a separator / final blending tank that has unique internal piping, along with an auto-purge system that results in very little standing water within the system at the end of the day. When combined with the Water Maze IPF2-20 Indexing Polishing Filter, the agglomerated solids and oils are removed from a clarified stream that can be recycled or discharged (as allowed by local regulations).

Compact CoAg standard features include:

- ¾ HP infeed pump mounted on the chassis with an external level control float switch (included)
- Four mixing chambers
- Four chemical injection ports
- Peristaltic injection pumps
- Integral electrical control center
- Infeed Pump and Peristaltic Pumps Interfaced with Flow Switch for automatic injection of chemicals and transfer of water from upstream through treatment process
- Steel components are phosphate cleaned and electrostatically painted
- Skid mounted steel chassis
- Automatic shut-down control system that monitors liquid levels in the two chemical solution tanks, as well as the media filter that is installed on the IPF filter unit (IPF available separately)

Some typical applications include:

- Treatment and discharge system, typically combined with a 150-gallon reservoir and IPF2-20D
- Recycle system, typically combined with a 150-gallon reservoir, IPF2-20D, REC2-20A multi-pump system, and a processed water storage tank
- Pretreatment, or post treatment to an existing water treatment system, typically installed upstream from a cone-bottom clarifier tank, or downstream from an oil/water separator



Compact CoAg

EQUIPMENT		
Model	Part Number	Description
Compact CoAg	1.103-510.0	Chemical Technology, up to 20 GPM, 120V, 1ph, 4 amps

*4 amps w/o infeed pump; 14 amps w/ infeed pump

OPTIONS AND UPGRADES	
Part #	Description
8.921-729.0	Factory installed - pH (only) Controller w/ one peristaltic pump electrically interfaced with the infeed pump / sump pump circuit
8.921-730.0	Factory mounted AMC-1000D, Auto-Purge System Includes: mounting of control center on the chassis of the Compact CoAg and the air actuated auto-purge valve supplied as a loose item (compressed air required 3 cfm @ 85 PSI)

EQUIPMENT - STANDARD SPECIALS		
Model	Part Number	Description
IPF 2/20D High-Boy	No Part#	High-Boy version of IPF2-20A Includes basic Indexing Polishing Filter w/ 10-inch taller legs and an 82-gallon water retention container



IPF High Boy

COMPACT COAG: CONFIGURATION EXAMPLES

(EXPECT EXTENDED DELIVERY TIMES ON SPECIAL CONFIGURATIONS)



COMPACT COAG — TREATMENT AND DISCHARGE SYSTEM SHOWN WITH:

Part #	Description
1.103-510.0	Compact CoAg
8.725-510.0	150-gallon Tank
8.751-972.0	Tank Stand
No Part#	IPF2-20D High Boy

The above system requires in-field supply and installation of interconnecting piping and fittings.

COMPACT COAG — SKID MOUNTED SPECIAL RECYCLE SYSTEM SHOWN WITH:

Part #	Description
1.103-510.0	Compact CoAg
8.921-730.0	AMC-1000D (installed)
8.921-729.0	pH Controller (installed)
8.725-510.0	150-gallon Tank
8.751-972.0	Tank Stand
1.103-488.0	IPF2-20D (standard)
8.917-279.0	42-gallon Retention Container
1.103-489.0	REC2-20A
8.917-651.0	Ozone Option (series 400)
No Part#	Special Steel Skid (special)

The above system includes interconnecting piping and fittings between components mounted to skid.

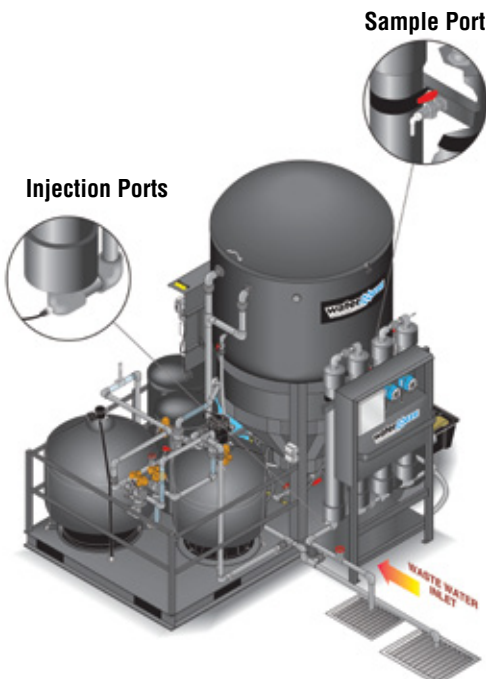

Compact CoAg Pre-Treatment System for CLP

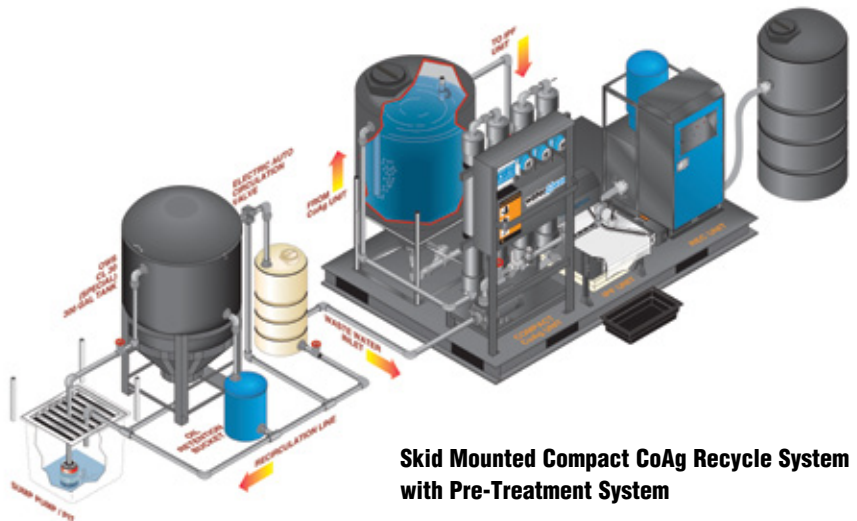

Skid Mounted Compact CoAg Recycle System with Pre-Treatment System

WASTE WATER TEST KIT: NOW YOU CAN DEMO WATER TREATMENT ON THE SPOT



EC+PLUS Test Kit

Now you can demonstrate to your customers on the spot just how well Water Maze's advanced EC+Plus technology can clean up their waste water.

This patent-pending technology, that integrates electrocoagulation and polymer injection, is easily demonstrated on site. Once the pH is adjusted the actual demonstration takes less than 1 minute. Once your customer sees how well EC+Plus technology works with

the toughest of waste streams, get ready to hear a "Wow!" Everyone comes away amazed that something so simple can clean up waste water so well and so quickly.



BEFORE

AFTER

COAG PLUS Test Kit



Show your customer what the CoAg System can do for their water with the CoAg Plus In-Field Demo Test Kit!

EQUIPMENT

Part #	Description
8.749-144.0	EC+Plus Waste water Test Kit
No Part #	CoAg Bench Scale Test Kit

WASTE STREAM ANALYSIS



The key to any water treatment system is an analysis of the waste stream to ensure the equipment is properly suited for the application and, in the case of evaporators, to determine what air quality permits are required, if any.

Water Maze offers several waste water test kits (below) as well as a variety of advanced waste water analyses (right).

WASTE WATER TEST KITS

Part #	Description
8.719-146.0	Evaporator Waste Stream Sampling Kit (1 kit only)
8.719-147.0	Bioremediation Waste Stream Sampling Kit (1 kit only)
8.749-144.0	EC+Plus Waste water Test Kit

WASTE WATER ANALYSES

Profile #	Description
8.750-241.0	Metal Analysis (includes Ag, As, Ba, Cd, Cr, Pb, Se Hg, Cu, Zn, Ni) Additional metals available upon request
8.750-242.0	Base Analysis for Evaporators (includes analysis of pH dissolved and suspended solids, Total Oils & Greases, NP [Non-Polar] Oils & Greases, Anions [Cl, NO ₃ , o-PO ₄ , SO ₄], Flashpoint, Viscosity, Cations [B, Ca, Fe, K, Mg, Na])
8.719-148.0	Base Analysis for Bioremediation (includes Total BOD, Dissolved BOD, TSS, COD TKN, Total Oils & Greases, Total Phosphorous, Ortho Phosphorous, Nitrate, TOC, Dissolved Phosphorus, CNP-Carbon, Nitrogen, Phosphorous)
8.750-243.0	VOC analysis (includes 67 VOC compounds by EPA 8260) For Evaporation Systems



CLB: MODULAR BIO-SYSTEM FOR RECYCLING OR DISCHARGING TO SANITARY SEWER -

SPECIAL OPTION AVAILABLE WITH AIR PUMP

For applications outside golf and turf markets, our waste water analysis #8.719-148.0 is required prior to ordering. See page 6 for details.

The Water Maze BioSystem or CLB series employs the latest bio-technology for treating and recycling commercial

and industrial waste water, including golf and turf applications where there's a high organic content in the wash water.

The CLB's unique design features modular components so the system is customized to match each customer's application requirements as well as to keep the equipment cost and performance to only what is truly needed. Moreover, the systems are automated for ease of maintenance.

Water Maze's advanced bio-technology features highly efficient aerobic microbial digesting, enhanced water circulation, injection of cultured microbes at concentrated levels and the introduction of a special microbial nutrients blend.

Unlike filtration systems, which create a sometimes hazardous sludge, the BioSystem naturally converts organic contaminants—such as oil, grease, etc. that are common to wash water—into harmless water and carbon dioxide.

Other features include: high-density, crosslinked, polyethylene tanks; water-resistant electronics control panel; and 2,087 sq. ft. of bio-media, with highly efficient injection of dissolved oxygen to enhance aerobic microbial digestion.

The customized, environmentally friendly BioStax 1800 consists of a special blend of non-pathogenic and non-toxic bacteria that provide an easy and effective way to control odor and dramatically reduce oil, grease and other hydrocarbons typically found in waste water. There are no hazardous byproducts.

The biology is further enhanced by Water Maze's BioNutrient, that is automatically injected into the water stream of the BioSystem.

CLB-30, auxiliary discharge tank for additional process capacity



Grass dumpster CLT-300 pre-treatment Recycled water holding tank CLB-603A, main bio-digestion unit CLT-600 polishing tank for enhanced bio-digestion



CLB-600, main bio-digestion unit for discharge system



TREATS GOLF, COMMERCIAL AND INDUSTRIAL WASTE WATER

EQUIPMENT					
Model	Part Number	Type of System	Bio-Media Surface	Tank Capacity	Volts/Phase Amps
CLB-603A	1.103-417.0	Recycle	2,087 sq ft	600 gal	230/1/20
CLB-600D	1.103-416.0	Discharge	2,087 sq ft	600 gal	120/1/9
CLB-30D	1.103-414.0	Auxiliary	2,087 sq ft	600 gal	120/1/1
CLT-600	1.103-435.0	Auxiliary	None	600 gal	N / A
CLT-300	1.103-434.0	Auxiliary	None	300 gal	N / A

OPTIONS, UPGRADES & ACCESSORIES

Part #	Description
WATERSTAX GOLF COURSE SYSTEMS	
8.903-602.0	Grass dumpster with SS mesh-lined dewatering screen
8.903-783.0	HydroScreen, stainless steel, grass slide assembly with hose Grass screen, stainless steel, for Hydroscreen
8.903-784.0	Mounting bracket for attaching HydroScreen to CLT-300
ADD-ONS TO ALL OR DESIGNATED BIO-SYSTEMS	
8.903-780.0	Pressure pump, 2 hp, for upsizing 3/4 hp pump (CLB-603)
8.903-785.0	Oil separation assembly, automatic, with collection tank, 26-gallon
8.906-478.0	Sludge tub with lid
8.903-781.0	pH Controller (CLB-603A)
8.903-787.0	pH Controller (CLB-600D)
No Part#	Factory Installed Air Pump System (CLB-603, CLB-600, CLB-30)

ACCESSORIES FOR CLB-30, CLT-300/600	
8.716-422.0	Auto-purge valve; valve only
8.903-782.0	Auto-purge valve; configured with CLB units
1.103-406.0	AMC-1000, Maintenance Control Retrofit Kit, 120V
8.715-367.0	Sump pump (for pumping water from collection pit)

PARTS	
Part #	Description
8.719-172.0	165-gallon flat bottom recycled water holding tank
8.712-417.0	Diffuser stone, fine pore, 6-1/2"
8.706-291.0	Fitting, compression 1/2" mpt x 3/8", 316 stainless steel
8.706-027.0	Coupler, 1/2", 316 stainless steel
8.707-435.0	Biomedica Bag
8.706-676.0	Eofill (Biomedica) 8 lbs / bag recommended

NOTE: CLB units require external supply of compressed air.

PM-1000: AUTOMATIC SYSTEM FOR BIOREMEDIATION PIT MANAGEMENT

If you face a smelly mess every Monday morning from a forgotten wash-water collection pit, Water Maze has a solution for you in the Pit Management System.

The PM-1000D provides a fully automated, environmentally friendly and low-cost way to manage standing wash water found in collection pits, tanks or sump drains.



Timers are located in a water-resistant control panel and automatically provide aeration and microbial injection.



Works Best With BioStax 1800
#8.718-919.0 Below

It is designed to be integrated into most wash-water treatment systems utilizing aeration and automatic injection of a highly effective microbial agent (BioStax 1800) for eliminating oils, greases and other hydrocarbons and organics typically found in collection pits or sump drains.

BioStax 1800 has proven to be very effective in controlling odor and converting oils, greases, and hydrocarbons into harmless carbon dioxide and water.

The aeration further enhances the effectiveness of the microbes and provides odor control.

Dimensions: 21"L x 30"W x 46"H
Ship Weight: 185 lbs.
ETL certified



EQUIPMENT		
Part #	Description	Volts/Ph/Amps
1.103-467.0	PM-1000D Pit Management System (Includes Air Compressor with Air Stones)	120/1/6

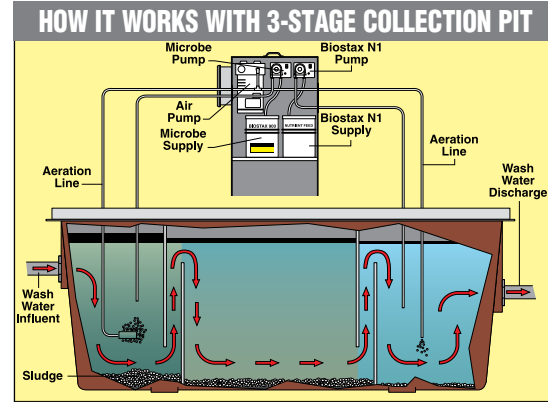

PM-1000 FEATURES AND BENEFITS:

- Easy in-field installation
- Fits most brands of water treatment systems
- Effectively reduces odor
- Biology consumes oils, grease, hydrocarbons, etc.
- Steel cabinet protected by epoxy powder coat finish

BIO-MEDIA: ALL-NATURAL SOLUTIONS FOR COLLECTION PITS & GREASE TRAPS



Water Maze provides a broad selection of bio-media used in bio-treatment systems, collection pits and even kitchen grease traps.

These all-natural products are made up of a special blend of non-pathogenic, non-toxic

bacteria designed for use in applications where pressure washers are typically found.

The products include:

■ **BioPuck HC:** An award-winning, microbial blend designed for naturally removing oil, grease and other hydrocarbons from a was-water collection pit; apply 1-2 tablets per month; available in package of four pucks; 4-pack package comes with containment nets and BioNutrient.

■ **BioPuck GT:** Bacterial blend formulated for naturally eliminating fats, cooking oils and greases found in a kitchen or food processing facility.

PARTS AND CONSUMABLES	
Part #	Description
8.718-913.0	BioPuck HC, 4-pack with BioNutrient and four pit socks
8.749-853.0	BioPuck HC, box of 20 pucks
8.718-914.0	BioPuck GT, 4-pack with four pit socks
8.718-918.0	BioStax 1800, liquid, 2 containers A&B (concentrate makes 55 gallons)*
8.718-917.0	BioStax 100 Hawaiian Blend, liquid, 8 oz. vial
8.718-919.0	BioStax 1800, Two 8 oz vials (A & B) makes 5 gallons
8.718-916.0	BioNutrient, powder, 8 oz vial

* Non-stock item



■ **BioStax 1800:** A two-part proprietary liquid blend of a non-toxic, non-pathogenic bacterial concentrate that is designed for slow release of microbes into the CLB BioSystem (see page 7). Also for use with the Pit Management System (see above). Comes in a kit made up of two 8-ounce bottles (designated "A" and "B") for mixing with water to make 5 gallons. Helps to control odor and the breakdown of hydrocarbons, greases and oils. Replaces BioStax 900. Certified by the ATCC as gram positive, class 1, pathogen-free organisms.

- **BioStax 100 Hawaiian Blend:** Designed for use in systems installed in Hawaii.
- **BioNutrient:** The Water Maze BioNutrient is a powder concentrate that mixes with water and enhances the effectiveness of the bioremediation process.

COLLECTION PITS: BELOW-GROUND PRE-TREATMENT OF WASTE WATER

Reinforced, pre-fabricated fiberglass pits are an economical in-ground, oil-water separator as well as provide ideal pre-treatment of wash-water.

The 3-stage collection pit is designed with baffles and for Water Maze's proprietary oil-coalescing plates to be inserted into the center chamber for enhanced separation.

This fiberglass separator is significantly easier and less expensive to ship and install than shipping or constructing on site collection pits made of concrete. The reinforced fiberglass sidewalls prevent bowing and underground movement.

The fiberglass collection pit works best when combined with a catch basin and sump pit, which are both made of the same chemical-resistant, reinforced fiberglass.

The wash water flows into the catch basin, where solids drop to the bottom. The runoff then flows into the collection pit. As it passes through the baffles, oil and other debris are separated from the water. In some instances, this is all that is needed to meet discharge limits for the sewer. If needed, a sump pit may be used to transfer waste water into a Water Maze water treatment system.

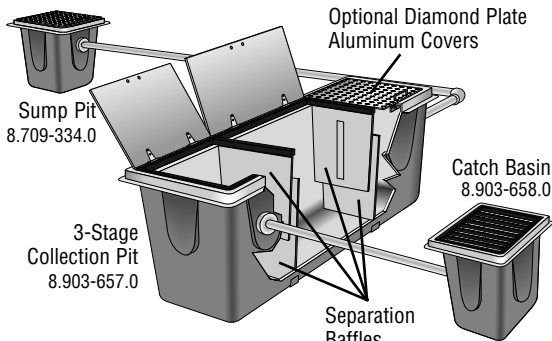

ACCESSORIES	
Part #	Description
8.903-657.0	Collection Pit, Fiberglass, In-Ground Oil-Water Separator, 36" x 108" x 54" (Inside Dimensions); 60 GPM
8.903-674.0	Cover for Collection Pit (#8.903-657.0), Hinged Aluminum Diamond Tread Plate w/ Steel Tube Frame, 3' x 9'
8.903-673.0	Coalescing Grid Packs, 58 Plates, 1,700 sq. ft. Surface Area
8.903-658.0	Catch Basin, Fiberglass, In-Ground, 3' x 3' x 4.5' (Inside Dimensions)
8.903-678.0	Cover for Catch Basin (#8.903-658.0), Aluminum Diamond Tread Plate, 3' x 3'
8.903-677.0	Grating for Catch Basin (#8.903-658.0), Hot Rolled Steel, 1/2" x 2" Flatbar, 1.5' x 3' (includes 2 grates) - *See note
8.709-334.0	Sump Pit, Fiberglass, In-Ground, 2' x 2' x 3' (Inside Dimensions)
8.903-675.0	Cover for Sump Pit (#8.709-334.0), Aluminum Diamond Tread Plate w/ Steel Tube Frame, 2' x 2'
8.903-676.0	Grating for Sump Pit (#8.709-334.0), Hot Rolled Steel, 1/2" x 2" Flatbar, 2' x 2' - *See note

* Gratings meet H-20 truck load rating.

PARTS	
Part #	Description
8.712-023.0	Wood Brace Kit (bracing to reinforce fiberglass while pouring concrete, Required for installation of Collection Pit Part# 8.903-657.0)

ALPHA: TOP-OF-THE LINE, INDUSTRIAL OIL AND WATER SEPARATOR

The Alpha is a highly effective above-ground oil-water separator, designed to discharge wash water to the sanitary sewer at rates of up to 30 GPM.

The genius of the Alpha is the proprietary "maze" design of up to 1000 sq. ft. of inclined coalescing plates which draw oils from wash water. The plates are strapped together in packs and are easily lifted out for cleaning.

Other features include:

- Up to 250-gallon stainless steel tank and aluminum lid for rust-free operation
- Ultra-violet ozone generator uses special mixing procedure to ensure up to 99% contact of bacteria-killing ozone in wash water
- Stainless steel baffles direct water flow for optimum treatment
- Automatic oil removal and disposal
- Specially designed sheen filter polishes the water before discharge
- Water-resistant control box for automatic operation of pumps



EQUIPMENT					
Model	Part Number	Flow GPM	Coalescing Area	Tank Size	Volts/Phase Amps
ALPHA-3100D	1.103-402.0	1-30	1000 sq ft	250 gal	120V/1/10
ALPHA-1500D	1.103-401.0	1-15	500 sq ft	125 gal	120V/1/10

OPTIONS AND UPGRADES	
Part #	Description
8.903-694.0	Auto-Water Discharge; automatically switches between recycle and discharge modes - *See note
8.903-647.0	ORP/pH Digital Controller, Model 250, 2 Pumps
8.913-331.0	Alpha Lid for 3100D, Aluminum
8.913-332.0	Alpha Lid for 1500D, Aluminum

* Auto-water discharge is also available through out Specials Department for other applications (i.e., CL600D, CL30A, etc.)

Note: Alpha Oil-Water Separators listed above no longer come standard with a sump pump. See page 24 for pump recommendations.

CLARIFIERS: SOLIDS / OIL & WATER / SEPARATION - DISCHARGE SYSTEMS

Water Maze CL and CLT clarifier systems are modular components that can be applied as pretreatment, post-treatment, or as a stand alone treatment system. All units utilize cross-linked polyethylene cone-bottom tanks with steep slopes (up to 55 degrees) for maximum solids separation. Each tank has a full open top with removable lid and includes heavy duty metal stand with cradle. Each model provides features and benefits to match your application requirements.

The **CLT-300** model includes:

A 300-gallon tank with lid; 3" inlet and 1 1/2" outlet bulkhead fittings; and manual purge valve at the bottom

The **CLT-600** model includes:

A 600-gallon tank with lid; manual purge valve at the bottom; 3" inlet and outlet bulkhead fittings; internal downward piping arrangement; and air diffuser stone mounted inside the tank

The **CL-30A** model includes:

A 600-gallon tank with lid; 1 1/2" inlet and outlet bulkhead fittings; a top divider cone and 2 lower coalescing cones; oil skimmer cone with outlet piping; 26-gallon oil decanter reservoir; 165-gallon poly tank with a 1/2 HP sump pump mounted inside; manual purge valve at the bottom; and sludge tub / dewatering container.

The **CL-600D** model includes:

A 600-gallon tank with lid; 1 1/2" inlet and outlet bulkhead fittings; a top divider cone and 9 lower coalescing cones; oil skimmer cone with outlet piping; 15-gallon oil decanter reservoir; manual purge valve at the bottom; sludge tub / dewatering container, series 400 UV ozone generator, mazzei injector, 1/2 HP circulation pump with timer control, 120 volt electrical control panel with mounting bracket.



CL-600D



DISCHARGE OR PRETREATMENT SYSTEMS					
Model	Part Number	Flow GPM	Recycle System	Ozone Generator	Volts/Phase Amps
CL-600D	1.103-410.0	1-30 GPM	No	24g/day	120/1/20
CL-30A	1.103-408.0	1-30 GPM	No	None	230/1/4.6
CLT-300	1.103-434.0	1-10 GPM	No	None	N/A
CLT-600	1.103-435.0	1-30 GPM	No	None	N/A
CL-30A	No Part#	300-gallon version of model CL-30A w/o the 165-gal tank and pump			

OPTIONS AND UPGRADES	
Part #	Description
8.903-695.0	Auto Purge - Automatically removes solids from CL-600 only cone-bottom tank (not applicable to CL-30 or CLT models; compressed air required, 3 cfm at 60-100 PSI)
8.903-651.0	ORP/pH Controller, Model 250, 2 Pumps, Factory Upgrade CL-600D only
No Part#	Auto-Water Discharge; automatically switches between recycle and discharge modes for CL-600D, CL-30A

ACCESSORIES	
Part #	Description
1.103-406.0	AMC-1000, Auto Purge Infield Retrofit Kit, 120V
8.716-989.0	pH-only Controller with probes, stand alone
8.715-379.0	VSP 20 metering pump, 120V
8.906-478.0	Sludge tub with lid

Note: Sump pumps are not supplied with the above products.

PH PERMISSIVE SYSTEM: AUTOMATICALLY ADJUSTS WATER PH



A pH Permissive System automatically monitors and adjusts the pH in a waste stream enhancing the effectiveness of waste water treatment systems, including an evaporator.

The unit continuously circulates the waste water monitoring and injecting pH adjusting agents using two chemical pumps. It also has an alarm for alerting the operator if the pH level is not reached in a set time eliminating the maintenance headaches sometimes associated with manually operated recycling systems.

EQUIPMENT	
Part #	Description
1.103-458.0	PH-3020D Digital pH Permissive System (120V, 9 amps)
8.903-682.0	Optional Auto Fill (SS sump pump, fittings and floats)
8.903-681.0	Optional Holding Tank, 300 gal. (valves and hose)

CLP: TOTALLY AUTOMATED WASH-WATER RECYCLING SYSTEMS



The CLP-7034 and 5024 are the standard models of the automated wash-water recycling systems.

They are totally automated using a digital sequencer to monitor and control the filtering, recirculating, filter backwashing and sludge dumping functions. Other CLP features include:

- Extra quantities of media including gravel, sand, anthracite and garnet



CLP-7034A

- 185 - 490 sq. ft. of cone-shaped coalescing plates for optimum separation of oil and solids from wash water
- Industrial-grade ozone generator
- Convenient, mess-free method of disposing of sludge from the system
- Up to 320 lbs. of auto "backwashable," degassed, virgin activated carbon

EQUIPMENT					
Model	Part Number	Flow GPM	Media Filter	Carbon Filter	Volts/Ph Amps
CLP-7034A	1.103-431.0	1-30	950 lbs.	320 lbs.	230/3/30
CLP-7034B	1.103-432.0	1-30	950 lbs.	320 lbs.	230/3/15
CLP-7034C	1.103-433.0	1-30	950 lbs.	320 lbs.	460/3/9
CLP-5024A	1.103-421.0	1-10	275 lbs.	200 lbs.	230/1/18
CLP-5024B	1.103-422.0	1-10	275 lbs.	200 lbs.	230/3/12
CLP-5024C	1.103-423.0	1-10	275 lbs.	200 lbs.	460/3/8

Note: Compressed air required for these models (3 cfm at 60-100 PSI)

OPTIONS AND UPGRADES	
Part #	Description
8.903-686.0	Upgrade Platform to Stainless Steel, CLP-7034
8.903-684.0	Upgrade Platform to Stainless Steel, CLP-5024

Notes: See page 19 for "Standard Specials" versions of CLP/Bioremediation Systems.

CLP Systems listed above no longer come standard with a sump pump. See page 24 for pump recommendations.

CL-304: ECONOMICAL RECYCLE SYSTEM

For very low-volume applications, the CL-304 offers a compact and affordable recycling system engineered to fit on a single platform.



CL-304A

Among the features are:

- Flow rate is 1-5 gallons
- Chlorination is used for sanitizing the waste stream
- Oil-water separation occurs in a 300-gallon tank with a coalescing pack of 94 sq ft of area
- The holding tank is 40 gallons and the dimensions are 72"L x 72"W x 90"H.

RECYCLE SYSTEMS					
Model	Part Number	Flow GPM	Recycle System	Ozone Generator	Volts/Phase Amps
CL-304A	1.103-409.0	1-5 GPM	Yes	Chlorinator	230/1/15

OPTIONS AND UPGRADES	
Part #	Description
8.903-683.0	Upgrade Platform to Stainless Steel, CL-304

Note: CL Systems listed above no longer come standard with a sump pump. See page 24 for pump recommendations.

FILTRATION KIT

FILTER PAC III (OPTION)

The Filter Pac III module can be applied for polishing waste streams in treat and discharge, as well as recycle applications.

Designed for flow rates of up to 30 GPM, the Pac III features carbon, cartridges and media filters for recycle quality wash water.



Filter Pac III

FILTER PAC III					
Model	Part Number	Media Filter	Carbon Filter	Cartridge Filter	Volts/ Phase Amps
PAC III	8.903-715.0	330 lbs.	300 lbs.	500 sq. ft.	230/1/10.5
PAC III	8.903-716.0	330 lbs.	300 lbs.	500 sq. ft.	230-460/3/5.6-2.8

WATER BLASTER: FOR PRE-WASHING

When heavy equipment and vehicles are laden with loads of dirt and mud, water volume is more effective than high pressure for a thorough cleaning.

The Water Blaster delivers up to 25 GPM of water volume—nearly 6 times more than most pressure washers—along with 500 PSI of pressure to knock off heavy dirt with ease.



Water Blaster: High volume (25 GPM) combined with moderate pressure (500 PSI)

Water Blasters come standard with:

- Two electrical configurations of an industrial-duty 10 hp motor with on-off motor control for convenience in washing away from the unit
- Rugged self-priming, high-pressure diaphragm pump mounted on vibration isolators
- Liquid level switches to ensure flow of water
- 100 ft. of 3/4-inch, abrasive-resistant hose with a variable fan wand

EQUIPMENT				
Part #	GPM	PSI	HP	Volts/Ph/Amps
1.103-484.0	25	500	10	230/3/30
1.103-472.0	25	500	10	460/3/15

PRETREATMENT SYSTEMS	
Part #	Description
1.103-435.0	CLT-600, 600-Gallon Cone-Bottom Tank and Stand
1.103-434.0	CLT-300, 300-Gallon Cone-Bottom Tank and Stand

PARTS	
Part #	Description
8.719-173.0	Vertical Poly, 310-Gallon Tank with Stand
8.711-863.0	Manually Operated Hose Reel only

STANDARD SPECIAL (EXPECT EXTENDED DELIVERY TIMES)

PRE-WASH SOLIDS SEPARATOR: FOR USE WITH WATER BLASTER

The Water Maze Pre-Wash Solids Separator quickly removes large amounts of dirt and mud from water used in cleaning earth-moving and other heavy equipment.

The water can then be recycled to a water cannon at a rate of up to 150 GPM for knocking off heavy dirt.

Unlike low-volume, high-pressure pumps used in pressure washers, high-volume pumps are much more effective in knocking off heavy dirt.

The separator is more than a pump and motor. It is an engineered wash-water recycling system that automatically draws water out of the wash pad collection pit, spins out the heavy solids using a cyclone separator, then sends it down the hose for re-use.

Solid Separators come standard with:

- Cast-iron centrifugal pump
- Energy-efficient electric motor
- Automatic fresh-water level controls
- Low level pump cut-off
- Remote on-off pump motor controls
- Foot valve
- Watertight electrical box and controls



Optional equipment available to use with the Pre-Wash Solids Separator include:

- 100-foot, heavy-duty, abrasive-resistant hose
- 100-foot capacity hose reel
- 100 GPM or 150 GPM adjustable nozzles that attach to the end of the fire hose

Model	Part Number	GPM	PSI	Motor	Inlet	Pump	Electrical
#30-759 B/C		150	100	15hp	230V 3ph 40 amp / 460V 3ph 20 amp	Cast Iron Centrifugal	NEMA 4, Mag Starter

MAINTENANCE CONTROLS: RETROFIT KITS FOR AUTOMATING SYSTEMS

The AMC-1000 is an in-field retrofit kit that automates the discharge function on Water Maze systems to dispense waste water and sludge from a system for disposal.

The AMC (Automatic Maintenance Control) kit is designed to automate the purging of the build up of solids in a cone-bottom tank of a water treatment system, such as a CLT-300, CLT-600, CL-30 or any above ground tank. The AMC operates on stand-alone 120V electrical.

■ **AMC-1000 (1.103-406.0):** This air-operated kit comes mounted in a NEMA box. A microtimer causes the air-activated purge valve to open discharging the sludge from the tank. Air supply (3 CFM @ 80-100 PSI) must be supplied by the customer.

A C C E S S O R I E S	
Part #	Description
1.103-406.0	AMC-1000, Maintenance Control Retrofit Kit, 120V

OZONE GENERATORS: FOR MICROBIAL AND ODOR CONTROL

This self-contained ozone generator is ideal as a stand-alone system for ridding waste water of odor and bacteria.

Ozone works up to 1000 times faster than chlorine, and other sanitizers, in killing bacteria without creating harmful byproducts. It also acts as a deodorizer.

Model 30-7501 includes an enclosed cabinet painted with a powder coat finish.

A unique mixing procedure ensures 99% contact by the bacteria-killing ozone with the wash water—a procedure far more effective than bubbling ozone into a tank.

Other features include: 3/4 hp circulation pump; 24-hour timer control; and 4 ultraviolet lamps which create 24 grams of ozone per day.

Ozone generators are also available for use in existing systems:

■ **Ultraviolet Systems:** Economical, high-efficiency generators with one, or four lamps producing up to 24 grams of ozone per day.

*Other models with higher ozone output are available through our specials dept. See page 20 for details.



A C C E S S O R I E S				
Model	Part #	Description	Flow Rate	Volts/Ph/Amps
30-7501	1.103-457.0	Ozone Generator	1-30 GPM	120/1/8



WASTE WATER EVAPORATION: HOW PATENTED TECHNOLOGY ENHANCES ENERGY EFFICIENCY

For years, evaporation has been an economical alternative to the high cost—as much as \$3 per gallon in some areas—of hauling waste water.

Because water typically makes up more than 90% of most waste streams, getting rid of the water through evaporation leaves only a small residue of waste to be disposed of properly at a much reduced cost and much reduced risk of cradle-to-grave liability.

Most evaporation equipment uses immersion tube technology to evaporate waste water. In 1994 Water Maze introduced a patented, super-energy efficient system using submerged combustion in which heat is forced through a submerged tube and released directly into the water for 100% heat exchanger efficiency and dramatic operational and energy cost savings.

U.S. PATENTS #5,381,742 AND #D357,056 AND CANADIAN PATENT #75,858 • OTHER PATENTS PENDING

WB: SUPER ENERGY-EFFICIENT WASTE WATER EVAPORATOR

The WB series is the first to use the extra-high efficient submerged combustion technology.

There are two models for handling waste streams at 60 and 120 gallons per hour.

Featuring top-of-the-line immersion tube jet burner components, with a solid-state flame control monitor, the WB models are capable of creating temperatures of up to 2000°F, releasing hot flue gases directly into the water.

Other features include:

- Heat-resistant, heavy-duty stainless steel sparger tube with unique air distribution system
- RF capacitance liquid level assembly for greater safety and enhanced operation
- Nema 4 electrical box with operational controls as well as troubleshooting indicator lights
- Auto purge, auto start/stop and auto fill come standard
- Soft-start ignition system and fast-closing UL, CSA and FM approved gas valve for smooth operation
- Stainless steel steam de-mister box
- Many safety features, including a UV scanner which shuts down the unit when a flame does not appear
- Foam suppression system and easy-to-access sludge disposal valve



EQUIPMENT				
Model	Part #	Flow Rate	BTU	Volts/Phase/Amps
WB-120A	1.103-473.0	1-120 GPH	1,142,000	230/1/30
WB-50A	1.103-474.0	1-60 GPH	571,000	230/1/20

Note: Compressed air required (4 cfm at 60-100 PSI)

OPTIONS AND ACCESSORIES	
Part #	Description

STAINLESS STEEL UPGRADES FROM 316L

- 8.903-729.0 Conversion of WB-120 Tank and Tube to AL-6XN*
- 8.903-725.0 Conversion of WB-50 Tank and Tube to AL-6XN*

CONVERSION KITS AND ACCESSORIES

- 8.906-066.0 Factory Conversion of WB-50/120 from Natural Gas to Propane
- 8.903-762.0 Foam Detection System
- 8.903-766.0 Waste water Flame Injection System, WB-50
- 8.903-767.0 Waste water Flame Injection System, WB-120

PARTS	
Part #	Description

- 8.717-742.0 10" Flue Pipe Rain Shield, WB-50
- 8.717-743.0 12" Flue Pipe Rain Shield, WB-120

* Expect extended lead times

SUBMERGED COMBUSTION TECHNOLOGY

HOW IT WORKS: NEW TECHNOLOGY DELIVERS 100% HEAT EXCHANGER EFFICIENCY WITH RELEASE OF HEAT DIRECTLY INTO THE WASTE WATER

The WB evaporator uses submerged combustion to deliver 100% heat exchanger efficiency sending the heat directly into the water, not up a vent stack, creating significant operational and energy cost savings.

Also, heat is not lost trying to get through the "insulation" of residual solids baked onto a heat exchanger.

The 100% heat exchanger efficiency has been verified by an independent testing laboratory.

Here's how it works:

A flame generated by a turbo, natural gas burner—fanned by a regenerative blower—rushes down a submerged sparger tube inside a cone-bottom tank filled with water. The heat is released directly into the water through openings in the tube. The surrounding water is immediately flash boiled.

The steam rumbles to the surface, heating more of the water as it rises, and is vented through an exhaust flue. Concentrated waste is collected in the tank bottom and automatically removed using the auto purge feature.

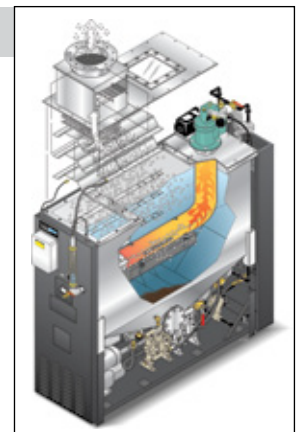



HBG: HIGH-EFFICIENCY WASTE WATER EVAPORATOR USING HOT-PLATE TECHNOLOGY

Water Maze offers several models of evaporators that use the conventional hot-plate technology with a unique high-efficiency combustion chamber.

There are two models of the HBG / HBE capable of evaporating waste water at 15 and 30 gallons per hour.

The natural gas-heated HBG systems have two models. The all-electric HBE, featuring eight 2600-watt coil-type heater, has one model with either 230V 3ph or 460V 3ph configurations.

The combustion box in the HBG models is made of advanced heat reflective material and features a unique energy-efficient design for reflecting the heat directly onto the floor of the evaporation tank for energy cost savings.

The unit is made of heavy-duty steel, insulated and double lined for energy efficiency and safety. Other features include:

- Heavy-duty tank made of carbon steel with optional alloy upgrades to 316L or AL-6XN stainless steel
- Non-fouling, stainless steel, liquid level assembly prevents damage to the system with a redundant third float for protection against overflowing;
- Nema 4 electrical box with operational controls as well as troubleshooting indicator lights
- High-efficiency burner shoots a flame, fueled by natural gas or propane, into the combustion chamber for unusually high energy efficiency
- Three-inch, recessed drain port for easy sludge removal



PARTS AND CONSUMABLES	
Part #	Description
8.717-742.0	10" Flue Pipe Rain Shield, HBG-30
8.717-740.0	6" Flue Pipe Rain Shield, HBG-15
8.719-138.0	5600 Defoamer, 1 Gallon
8.719-139.0	5600 Defoamer, 5 Gallons
8.719-140.0	5600 Defoamer, 55 Gallons
8.749-779.0	Defoamer A-32, 5 Gallons (for use with metal working coolants)
8.749-782.0	No Rust Corrosion Inhibitor, 5 Gallons (concentrate)
8.749-781.0	No Rust Corrosion Inhibitor, 55 Gallons (concentrate)

EQUIPMENT					
Model	Part #	Flow Rate	BTU	Volts/Ph/Amps	Tank
HBG-30D	1.103-449.0	1-30 GPH	390,000	120 / 1 / 3	100 gal
HBG-15D	1.103-448.0	1-15 GPH	200,000	120 / 1 / 3	70 gal

Note: HBE (electric evaporators) with options are available through the specials department. See page 18 for standard specials section for details.

OPTIONS AND ACCESSORIES	
Part #	Description

STAINLESS STEEL TANK UPGRADES FROM CARBON STEEL

8.903-749.0	Conversion of HBG-30 Tank to 316L Stainless Steel
8.903-750.0	Conversion of HBG-30 Tank to AL-6XN
8.903-746.0	Conversion of HBG-15 Tank to 316L Stainless Steel
8.903-747.0	Conversion of HBG-15 Tank to AL-6XN

AUTO FILL FACTORY CONVERSION KIT

8.903-740.0	Air Diaphragm Fill Pump & Level Controls for Auto Fill; HBG-30, HBG-15 (compressed air required, 3 cfm at 60-100 PSI)
8.903-753.0	Electric Centrifugal Fill Pump & Level Controls for Auto Fill, HBG-15/30

CONVERSION KITS AND ACCESSORIES

8.906-076.0	Factory Conversion of HBG-15 from Natural Gas to Propane
8.906-077.0	Factory Conversion of HBG-30 from Natural Gas to Propane

MOTORIZED BELT OIL SKIMMER

8.903-741.0	Motorized Belt Oil Skimmer, 316L Stainless Steel
-------------	--

CHEMICAL ADDITION SYSTEM

8.906-074.0	Chemical Injector, Defoamer, Air-Injected Use with Conversion Kit Above #8.903-740.0 and 8.903-739.0
8.906-073.0	Inline Chemical Injector, for Anti-foam or Rust Inhibitor, Electric-Powered. Use with Auto Fill Conversion Kits Above #8.903-740.0 and 8.903-753.0

EVAPORATOR BELT: ECONOMICAL ALTERNATIVE FOR LOW-VOLUME EVAPORATION



The Evaporator Belt is ideal for evaporating very low volumes of waste water.

The electric-powered belt wraps around a standard 55-gallon steel drum and slowly heats non-flammable liquids to temperatures of 70° to 250°F.

The heavy-duty aluminized steel belt includes thermostatic control and weighs only 14 lbs.

EQUIPMENT	
Part #	Description

8.707-034.0	Wrap-It-Heat Water Reduction Drum Heater Evaporation Rate of 1.4 GPH (230V, 1ph, 12.5 amps)
-------------	--

Note: Drum not included

ORP/PH CONTROLLER



Maintaining the proper ORP/pH levels is vital in wash-water treatment. Digital controllers are available to monitor and automatically inject chemicals. The controller includes ORP/pH pumps, monitoring probes and necessary electrical and plumbing connections.

PARTS

Part #	Description
8.903-647.0	ORP/pH Digital Read-Out Controller, Model 250, with 2 Pumps (VSP 20); for Alpha, Factory Installed
8.903-651.0	ORP/pH Digital Read-Out Controller, Model 250, with 2 Pumps (VSP 20); for CL-600D; Factory Installed
8.716-989.0	pH-only Controller, with probe; Field Installed Only Requires VSP20 Metering Pump, 120V (#8.715-379.0)
8.715-378.0	VSP20 Metering Pump, 24VAC
8.715-379.0	VSP20 Metering Pump, 120V

STORAGE TANKS & SPECIALTY KITS

Polyethylene storage tanks are ideal for expanding the capacity of a water filtration system or simply to serve as a "cushion" in handling high volumes of wash-water. All are UV- and corrosion-resistant.



8.719-173.0

PARTS

Part #	Description
STORAGE TANKS	
8.719-173.0	Storage Tank, Polyethylene, 310 gal., Cone Bottom with Stand
8.719-172.0	Intermediate Storage Tank, Polyethylene, 165 gal., Flat Bottom
8.725-510.0	150 Gallon. Cone Bottom Tank
8.751-972.0	CB Tank Stand, 150 gallon, 36" (45 degree)
1.103-435.0	CLT-600 Gallon Tank and Stand
1.103-434.0	CLT-300 Gallon Tank and Stand

TEST KITS

8.712-138.0	Ozone Flowmeter
8.720-009.0	Chlorine Test Strips
8.720-010.0	pH Test Strips

PIT CLEANER: FOR SLUDGE REMOVAL

Cleaning sludge from the bottom of a collection pit is neither easy nor fun. But the Pit Cleaner makes it bearable.

An extended wand is attached to a pressure washer, with a minimum of 1000 PSI. The pressure is channeled so that it creates a vacuum, capable of suctioning mud and sludge from the bottom of a pit or even a pond.

The sludge is deposited into a porous collection bag, mounted on a hand truck, where the water drains out and the sludge is allowed to dry for eventual disposal.



ACCESSORIES

Part #	Description
8.903-600.0	Pit Cleaner (includes wand and hose only)
8.709-206.0	Sludge Cart Only (includes 5 bags)
8.903-601.0	Shallow Pit Cleaner (up to 2 feet deep), Qty 1

PARTS

Part #	Description
8.719-191.0	Sludge Bag (biodegradable, cotton fiber), Qty 1

STANDARD SPECIAL (EXPECT EXTENDED DELIVERY TIMES)

**CL-304:
ECONOMICAL RECYCLE SYSTEM
WITH BIOREMEDIATION**

For low-volume applications, the CL-304 offers a compact and affordable recycling system engineered to fit on a single platform.

Among the features are:

- Flow rate is 1-5 gallons
- In lieu of the normal oil/water separator tank, the 300-gallon clarifier tank is converted to a bio-digester with bags of Eofill (Biomedica). Multiple air-diffuser stones are installed in the clarifier and the components of a PM-1000 (i.e. microbe and nutrient injection pumps, and air pump) are incorporated into the unit
- The holding tank is 40 gallons; the dimensions are 72" L x 72" W x 90" H
- Includes air pump installed on skid



RECYCLE SYSTEMS					
Model	Part Number	Flow GPM	Recycle System	Ozone Generator	Volts/Phase Amps
CL-304A - Biosystem	<i>Available through Specials Department</i>				
Specs: same as CL-304A on page 11 without chlorinator, but with microbial and nutrient injection and aeration system					

OPTIONS AND UPGRADES	
Part #	Description
8.903-683.0	Upgrade Platform to Stainless Steel, CL-304
No Part#	pH (only) Control Option

Note: CL Systems listed above no longer come standard with a sump pump. See page 24 for pump recommendations.

CL-304A (special)



CLARIFIERS: SOLIDS / OIL & WATER / SEPARATION - DISCHARGE SYSTEMS

Water Maze CL clarifier systems are modular components that can be applied as pretreatment, post-treatment, or as a stand alone treatment system. All units utilize cross-linked polyethylene cone-bottom tanks with steep slopes (up to 55 degrees) for maximum solids separation. Each tank has a full open top with removable lid and includes heavy duty metal stand with cradle. Each model provides features and benefits to match your application requirements.

The **CL-600D** model includes:

- 600-gallon tank with lid
- 1 1/2" inlet and outlet bulkhead fittings
- Top divider cone and 9 lower coalescing cones
- Oil skimmer cone with outlet piping
- 15-gallon oil decanter reservoir
- Manual purge valve at the bottom
- Sludge tub / dewatering container
- Series 400 UV ozone generator
- Mazzei injector
- 1/2 hp circulation pump with timer control
- 120 volt electrical control panel with mounting bracket

The **CL-30A Special** model includes:

- 300-gallon tank with lid
- 1 1/2" inlet and outlet bulkhead fittings
- Top divider cone and 2 lower coalescing cones
- Oil skimmer cone with outlet piping
- 15-gallon oil decanter reservoir
- Manual purge valve at the bottom
- Sludge tub / dewatering container
- No electrical included

DISCHARGE OR PRETREATMENT SYSTEMS					
Model	Part Number	Flow GPM	Recycle System	Ozone Generator	Volts/Phase Amps
CL-600D	1.103-410.0	1-30 GPM	No	24g/day	120/1/20
CL-30A	No Part#	300-gallon version of model CL-30A without the 165-gal tank and pump			

OPTIONS AND UPGRADES	
Part #	Description
8.903-695.0	Auto Purge - Automatically removes solids from CL-600 only cone-bottom tank (not applicable to CL-30 or CLT models; compressed air required, 3 cfm at 60-100 PSI)
8.903-651.0	ORP/pH Controller, Model 250, 2 Pumps, Factory Upgrade CL-600D only
No Part# (special)	Auto-Water Discharge; automatically switches between recycle and discharge modes for CL-6000, CL-30A

ACCESSORIES	
Part #	Description
1.103-406.0	AMC-1000, Auto Purge Infield Retrofit Kit, 120V
8.716-989.0	pH-only Controller with probes, stand alone
8.715-379.0	VSP 20 metering pump, 120V



CL-600D

CL-30A

STANDARD SPECIAL (EXPECT EXTENDED DELIVERY TIMES)

STAINLESS HBG: EVAPORATOR WITH A STAINLESS STEEL EXTERIOR



The HBG waste water evaporator, which uses the conventional hot-plate technology, also is available with a stainless steel exterior (lower heat chamber and upper tank wrap) as a standard special.

The HBG-30D-SS features Water Maze's unique high-efficiency combustion chamber and is natural gas- or LP-heated. Evaporation rate is up to 30 gallons per hour.

The unit is made of heavy-duty steel inside and is insulated and double lined for energy efficiency and safety.

EQUIPMENT				
Model	Flow Rate	BTU	Volts/Phase/Amps	Tank
HBG-30D	1-30 GPH	390,000	120/1/3	100 gal

See page 15 for standard HBG options and accessories

HBE: HIGH-EFFICIENCY WASTE WATER EVAPORATOR

The all-electric HBE, featuring eight 2600-watt coil-type heater, has one model with either 230V 3ph or 460V 3ph configurations. They are both capable of evaporating waste water at 8 gallons per hour.

Features include:

- Heavy-duty tank made of carbon steel with optional alloy upgrades to 316L or AL-6XN stainless steel
- Non-fouling, stainless steel, liquid level assembly prevents damage to the system with a redundant third float for protection against overflowing
- Nema 4 electrical box with operational controls as well as troubleshooting indicator lights
- High-efficiency burner shoots a flame, fueled by natural gas or propane, into the combustion chamber for unusually high energy efficiency
- Three-inch, recessed drain port for easy sludge removal



EQUIPMENT					
Model	Part #	Flow Rate	BTU	Volts/Ph/Amps	Tank
HBE-10B	No Part#	1-8 GPH	N/A	230 / 3 / 57	55 gal
HBE-10C	No Part#	1-8 GPH	N/A	460 / 3 / 28	55 gal

OPTIONS AND ACCESSORIES	
Part #	Description

STAINLESS STEEL TANK UPGRADES FROM CARBON STEEL

No Part#	Conversion of HBE-10 Tank to 316L Stainless Steel
No Part#	Conversion of HBE-10 Tank to AL-6XN
No Part#	Electric Centrifugal Fill Pump & Level Controls for Auto Fill, HBE-10B
No Part#	Electric Centrifugal Fill Pump & Level Controls for Auto Fill, HBE-10C

KITS AND ACCESSORIES

No Part#	Chemical Injector, Defoamer, Air-Injected
-----------------	---

STANDARD SPECIALS (EXPECT EXTENDED DELIVERY TIMES)

CLPB WITH BIO: AUTOMATED RECYCLING SYSTEMS WITH BIOREMEDIATION

The CLPB combines CLP filtration technology with our advanced bio-technology used in the CLB systems. Modifications made to the CLP include: removing the coalescing cones and adding bio-media, an air diffuser stone and an inverted lower cone; removing the ORP/ph controller and adding a pH-only controller; the addition of microbes and nutrient injection; ozone is injected into tank #2 only (clean water tank); a bleeder line is installed so that water constantly flows from tank #1 to the pit system. All CLPB units include an air pump installed on the skid.



CLPB-7034A



**This equipment is not supplied with ETL/UL certification.*

EQUIPMENT					
Model	Flow Rate GPM	Media Filter	Carbon Filter	Volts/ Phase Amps	List Price
CLPB-7034A	1-30	950 lbs.	320 lbs.	230/1/30	
CLPB-7034B	1-30	950 lbs.	320 lbs.	230/3/15	
CLPB-7034C	1-30	950 lbs.	320 lbs.	460/3/9	
CLPB-5024A	1-10	275 lbs.	200 lbs.	230/1/18	
CLPB-5024B	1-10	275 lbs.	200 lbs.	230/3/12	
CLPB-5024C	1-10	275 lbs.	200 lbs.	460/3/8	

Note: Compressed air required for these models (4 cfm at 60-100 PSI)

CLPB Systems listed above no longer come standard with a sump pump. See page 24 for pump recommendations.

STANDARD SPECIALS (EXPECT EXTENDED DELIVERY TIMES)

**SPECIAL OZONE SYSTEMS:
DELIVERS UP TO 72 GRAMS PER DAY OF UV OZONE**

This self-contained ozone generator system is ideal as a stand-alone system for ridding waste water of odor and bacteria. Ozone works up to 1000 times faster than chlorine and other sanitizers in killing bacteria without creating harmful by-products. It also acts as a deodorizer.

The system utilizes (3) three Water Maze Series 400 UV ozone generators and one control cabinet. Two of the ozone generators will need to be field installed on a wall-mount bracket (bracket not included). The standalone control cabinet includes a circulation pump, 24-hour timer control, and inlet / outlet PVC connections. A larger piping manifold with mazzei injectors are supplied to ensure 99% contact by the bacteria-killing ozone with the wash water - a procedure far more effective than bubbling ozone into a tank.

The cabinet enclosure is painted with a powder coat finish. Each ozone generator cabinet is made of stainless steel.

*Other models with higher ozone output are available through our specials dept.



EQUIPMENT			
Part #	Description	Flow Rate	Power Requirements
No Part#	72 grams/day Ozone Generator System	40-50 GPM	Two (2) 120V / 20 Amp Circuits

STANDARD SPECIAL (EXPECT EXTENDED DELIVERY TIMES)

ENVIRONMENTAL CONTAINMENT RACKS / STEEL WASH PADS

The Water Maze above ground containment rack systems makes shipping and installing a wash rack easier than ever. With no permitting required, this bolt together system can be installed in a matter of hours.

The low profile modular design with a maximum deck height of 6 inches (15.24 cm) can be purchased in various sizes and configurations to meet your current site requirements. The modular design also allows for shipping under LTL freight rates, or inside of an ocean cargo container for export purposes.

FEATURES AND BENEFITS:

- Multiple Ramp options available:
Drive-On / Back-Off or Drive-Through
- Available in 9' wide and 18' wide models
- Diamond plate deck surface
- Deck height 6"

DRIVE-ON / BACK-OFF CONFIGURATION (18 FEET WIDE MODEL)



DRIVE-ON / BACK-OFF CONFIGURATION (9 FEET WIDE MODEL)

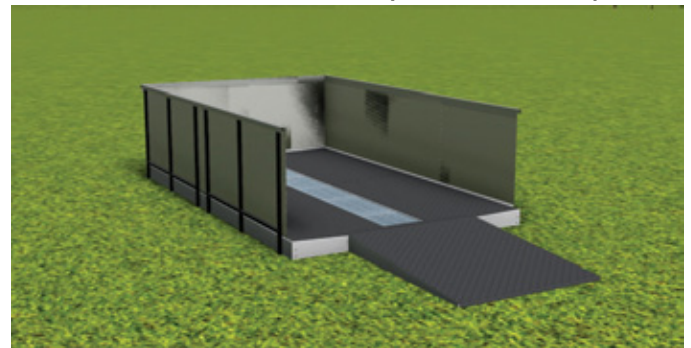

DRIVE-THROUGH CONFIGURATION (18 FEET WIDE MODEL)



SHOWN W/ OPTIONAL CANOPY



CONVEYOR OPTION (FOR 18 FEET WIDE OR GREATER CONTAINMENT RACKS)

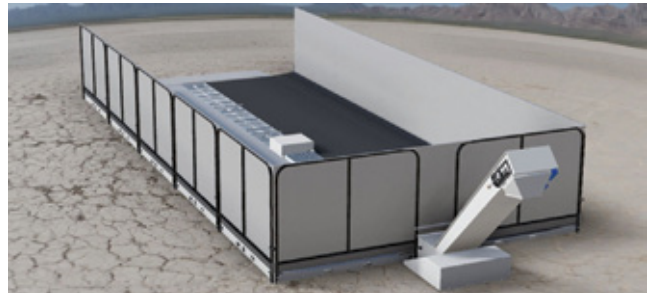
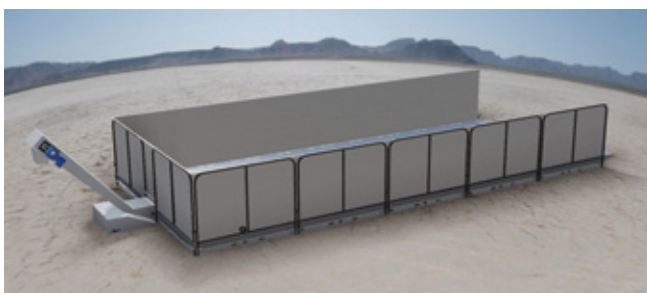



STANDARD SPECIALS (EXPECT EXTENDED DELIVERY TIMES)

CONTAINMENT RACK SPECIFICATIONS - 9 FEET WIDE:

DIMENSIONS:	Inside width= 9 feet (2.743 meters), Inside lengths: increments of 7 feet (2.133 meters)
CAPACITY:	15,000 lbs. (6,818 kgs.) weight support distributed over a typical four-wheeled point contact in a 6' x 6' (1828 mm x 1828 mm) area.
MODULAR DECK & TROUGH DESIGN:	Lower deck consists of one section that is 9' (2.743 meters) wide x 7' (2.133 meters) long and incorporates a center trough that is approximately 24"(609 mm) wide x 4.5"(114 mm) deep and includes removable steel gratings that run full length. The outer deck height is 6" (152 mm) high and tapers towards the center trough. Multiple sections are bolted together (using alignment pins and seal strips) to match the overall deck length requirements.
OVERSPRAY WALLS:	6' high tubular steel with galvanized sheet metal.
LAYOUT (options):	<i>Drive-on / back-off</i> with ONE SET of low angle approach ramps and overspray walls on three sides. <i>Drive-through</i> with TWO SETS of low angle approach ramps and overspray walls on two sides.
MATERIALS OF CONSTRUCTION:	Custom U-channel steel fabricated substructure with diamond tread plate surface; tubular steel overspray walls with galvanized sheet metal covering.
METAL FINISHING:	Steel components are deep cleaned with a phosphate cleaning solution and then painted with a 2-step epoxy paint process. Diamond tread deck surface has a grit impregnated coating.

CONTAINMENT RACK SPECIFICATIONS - 18 FEET WIDE:

DIMENSIONS:	Inside width: 18 feet (5.486 meters) Inside lengths: increments of 7 feet (2.133 meters)
CAPACITY:	60,000 lbs. -27,273 kgs. weight support (15,000 lbs. – 6,818 kgs. for typical four-wheeled point vehicle)
MODULAR DECK & TROUGH DESIGN:	Lower deck consists of sections. Section A = 10' wide x 7' long (3.04 m x 2.133 m), and Section B = 8' wide x 7' long (2.438 m x 2.133 m). The 10' wide section incorporates a center trough that is approximately 24"(609 mm) wide x 4.5"(114 mm) deep and includes removable steel gratings that run full length. The outer deck height of each section is 6" (152 mm) high and tapers towards the center trough. Multiple sections of A and B are bolted together (using alignment pins and seal strips) to match the overall deck length requirements.
OVERSPRAY WALLS:	6' high tubular steel with galvanized sheet metal. 12' high tubular steel with outer support braces. (OPTIONAL)
LAYOUT (options):	<i>Drive-on / back-off</i> with ONE SET of low angle approach ramps and overspray walls on three sides. <i>Drive-through</i> with TWO SETS of low angle approach ramps and overspray walls on two sides.
MATERIALS OF CONSTRUCTION:	Custom U-channel steel fabricated substructure with diamond tread plate surface; tubular steel overspray walls with galvanized sheet metal covering.
METAL FINISHING:	Steel components are deep cleaned with a phosphate cleaning solution and then painted with a 2-step epoxy paint process. Diamond tread deck surface has a grit impregnated coating

AVAILABLE OPTIONS:

- **CUSTOM DECK WIDTHS** available upon requests.
- **INTEGRATED UNDERCARRIAGE RINSE SYSTEM:** 60 GPM @ 100 PSI, consisting of:
 - A 10' long spray bar system with 10 spray nozzle pockets welded into the deck plate so all the nozzles are sub surface.
 - The above is embedded into one set of the above deck sections (an "A" and "B" section).
 - A pumping system: centrifugal booster pump with enclosed impellers.
- **DUAL DIAPHRAGM PUMP RECOVERY SYSTEM:**
 - Includes heavy duty suction pumps (x2) that are capable of pumping heavy solids at a flow rate to keep up with the above undercarriage rinse system; flow activation of pumping system using PLC electrical interface with the customer supplied pressure washer and/ or water blaster system; hoses and hose connections from one end of the drain trough to the pump rack.
- **INTEGRATED CONVEYOR SYSTEM:** Automatically removes solids from the center trough system. Available for 18 feet wide or greater containment racks.
- **CANOPY COVERS:** Available to fit all models.
- **TREATMENT & DISCHARGE SYSTEMS**
- **RECYCLE SYSTEMS**

STANDARD SPECIAL (EXPECT EXTENDED DELIVERY TIMES)

VEHICLE WASH SYSTEM

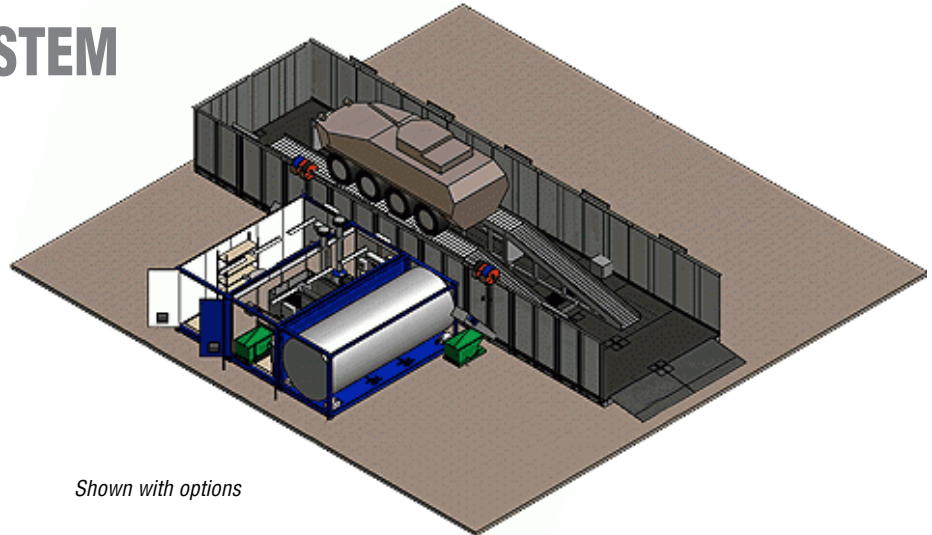

Shown with options

EQUIPMENT

Model	Part #	Description
VWS -1100	No Part#	Complete System (Includes 3 items below)
VWS-1103	No Part#	Filtering recycling system in all weather ISO container. 100 GPM, 5 micron absolute, heavy mud. Includes electrical distribution, storage, heated, lighted, ISO certified. Includes 2 hot water pressure washers, 2 water cannons. Includes manuals, parts lists, training package, engineering reports, ISL, PPL, EHSIR, ISO certification.
VWS-1125	No Part#	42' x 18' wash rack, 160,000 lb. capacity, overspray wall on side and back, drive on ramp, collection trough, ISO containers
RIV 214143-1100	No Part#	Hose reel assembly

OPTIONS AND ACCESSORIES

Model	NSN	Description
VWS-1125-500	No Part#	18' x 7' x 160,000# rack section with hardware
RIV 214058-1000	No Part#	6' x 7' wall section with hardware
VWS-1138-500	No Part#	18' x 5 x 160,000# continuous ramp section
VWS APUW001	No Part#	common pump assy 5HP (water cannon, filter, pressurized line feed/ozone) TEFC Cast Iron
FIBG25FF	No Part#	Filter Package (box of 10 filters, 5 micron absolute, multi-layer oil adsorbing)
VWS-1001	4940-01-596-2254	Complete Vehicle Wash System including: 63' x 18' wash pad with 160,000 lb. capacity, 2 each rack drag conveyors with wedge wire screen filters and dump hoppers, 6' high over spray walls on three sides, 49' long inspection ramp with 160,000 lb. capacity with rack connections, two hot water pressure washers, one 30 GPM @100 PSI water cannon, hose reels mounted on rack with remote controls, recycling filtration system with automatic mud conveyor and filtration to 5 micron absolute, 4000 gallon water tank, CAT diesel generator, High velocity industrial vacuum system with two drops, CARC painted custom ISO containers to ship and store all rack and ramp components.
VWS-1003	4610-01-596-2135	VWS filtration system in all weather ISO
VWS-1002	6115-01-596-3120	Generator and Vacuum system for VWS in all weather ISO
VWS-1004	8145-01-596-3455	ISO container with two each 2,000 gallon water tanks, heated and lit. Contains hose reel mount for wash rack
VWS-1025	4940-01-596-2259	18' x 63' drive on/back off wash pad with 2 drag conveyors, 160,000 lb. capacity
VWS-1009	3990-01-596-2095	49' elevated inspection ramp, 160,000 lb. capacity, secures to wash rack or stand alone. VWS-1009 consists of (1) VWS-1007 and (1) VWS-1008, along with the following (if ordered individually):
VWS-WRA		Inclined Wash Ramp Assembly
VWS-CHER		Central Horizontal Elevated Rack
VWS-1005	8145-01-596-8403	Rack storage container with cassetts for securing racks 1
VWS-1006	8145-01-596-8400	Rack storage container with cassetts for securing racks 2
VWS-1007	8145-01-596-3454	Ramp storage container with secure fixtures 1
VWS-1008	8145-01-596-8401	Ramp storage container with secure fixtures 2



WATER MAZE FILTER CAPACITIES

Model Number	Gravel 1/4 x 1/8 8.718-921.0	Garnet 30 x 40 8.718-923.0	Garnet 8 x 12 8.718-924.0	Sand .45-.55 mm 8.718-920.0	Anthracite #1 .60-.80 mm 8.718-922.0	Carbon Activated 8.718-933.0	Element 100 sq/ft 20 micron 8.716-872.0	Element 200 sq/ft 20 micron 8.716-840.0	Element 250 sq/ft 20 micro 8.716-847.0
CLP-5023	100 lb	–	–	150 lb	25 lb	100 lb	–	1	–
CLP-5024	100 lb	50 lb	50 lb	50 lb	25 lb	100 lb	–	–	–
CLP-7023 (current)	100 lb	–	–	200 lb	30 lb	150 lb	–	–	2
(Prior to 2-01-00)	100 lb	–	–	200 lb	30 lb	150 lb	–	2	–
CLP-7033 (current)	350 lb	–	–	450 lb	100 lb	160 lb	–	–	2
(Prior to 4-05-01)	400 lb	–	–	500 lb	100 lb	225 lb	–	–	2
(Prior to 2-01-00)	400 lb	–	–	500 lb	100 lb	225 lb	–	2	–
(Prior to 2-22-99)	100 lb	–	–	200 lb	30 lb	150 lb	–	2	–
CLP-7034	350 lb	300 lb	200 lb	100 lb	100 lb	160 lb	–	–	–
CLP-8034 (current)	200 lb	100 lb	200 lb	50 lb	50 lb	160 lb	–	–	–
(Prior to 8-29-01)	300 lb	–	–	300 lb	50 lb	225 lb	–	–	–
CLP-9044 (current)	350 lb	300 lb	200 lb	100 lb	100 lb	350 lb	–	–	–
(Prior to 8-29-01)	400 lb	–	–	500 lb	100 lb	600 lb	–	–	–
CL-304	100 lb	–	–	200 lb	30 lb	–	1	–	–
Filter Pac I (30-780)	–	–	–	–	–	150 lb	–	1	–
Filter Pac II (30-779) (curr.)	–	–	–	–	–	160 lb	–	–	2
(Prior to 8-31-01)	–	–	–	–	–	225 lb	–	2	–
Filter Pac III (30-778) (curr.)	100 lb	–	–	200 lb	30 lb	150 lb	–	2	2
(Prior to 5-20-04)	100 lb	–	–	200 lb	30 lb	150 lb	–	2	–
Delta-1500 (current)	200 lb	–	–	300 lb	100 lb	100 lb	–	–	2
(Prior to 8-30-01)	300 lb	–	–	300 lb	50 lb	100 lb	–	2	–
Delta-3000 (current)	350 lb	–	–	450 lb	100 lb	150 lb	–	–	2
(Prior to 8-30-01)	400 lb	–	–	500 lb	100 lb	150 lb	–	2	–

All media sold in 50 lb bags, except garnet which is sold in 100 lb bags. Carbon weights are dry weight.

A GUIDE FOR MATCHING SUMP PUMPS TO WATER MAZE SYSTEMS

Models	Grundfos 1/2HP, 120V 8.715-364.0	Little Giant 1/2HP, 120V 8.715-367.0	Little Giant 1/2HP, 230V/1ph 8.715-368.0	Little Giant 1/3HP, 230V/1ph 8.715-369.0	Ebara SS 1/2HP, 230V/3ph 8.715-438.0	Ebara SS 1/2HP, 460V/3ph 8.715-439.0
CLP-7034A			■			
CLP-7034B					■	
CLP-7034C						■
CLP-5024A				■		
CLP-5024B					■	
CLP-5024C						■
CL-603A			■			
CL-600D		■				
CL-304A				■		
Alpha-1500D	■					
Alpha-3100D	■					



Detergents, Defoamers & Additives

For Waste Water Treatment Systems

PRICE LIST - 2014



QUICK RELEASE DETERGENTS - FOR WASH WATER APPLICATIONS

Enviro-Clean

Water Maze Enviro-Clean is an all-purpose detergent designed to be used through a pressure washer and still have the quick release properties for use with a wash water recycling system or oil-water separator. It is completely biodegradable and phosphate free. Water Maze Enviro-Clean can be used safely on many surfaces, including aluminum, stainless steel, glass, plastic, paint and even fine automotive paint finishes.

5 gal. (8.916-591.0) | 55 gal. (8.916-594.0)

Quick Release
Phosphate Free
All Purpose Detergent

Enviro-Clean+Plus

Water Maze Enviro-Clean+Plus combines both the cleaning power of other detergents with oil-release properties to enhance the effectiveness of a wash water recycling system or oil-water separator. In addition to being biodegradable, it has low-foaming and low-phosphate characteristics and contains no caustics or butyls. Water Maze Enviro-Clean+Plus can be used safely on many surfaces, including aluminum, stainless steel, glass, plastic, paint and even fine automotive paint finishes. It is ideal for cars, trucks, machinery, exterior walls, heavy equipment, farm implements, RVs, drilling rigs, mining equipment, buses, and other items that may require use a recycling system or oil-water separator.

5 gal. (8.916-589.0) | 55 gal. (8.916-592.0)

Quick Release
Low Phosphate
All Purpose Detergent

Enviro-Degreaser

Water Maze Enviro-Degreaser is a potent degreaser that also has quick-release properties so it is ideal for use when water is being treated by a wash water recycle system or oil-water separator. Besides being biodegradable, Water Maze Enviro-Degreaser is phosphate free and does not react photochemically so it's enviro-safe. Water Maze Enviro-Degreaser can be used safely on many surfaces, including aluminum, stainless steel, glass, plastic, paint and even fine automotive paint finishes. It is ideal for use on vehicles, engines and other other objects exposed to high amounts of grease and grime. It is especially effective as a pre-spray for cleaning engines, white-wall tires, vinyl tops and metal tops.

5 gal. (8.916-590.0) | 55 gal. (8.916-593.0)

Quick Release
Phosphate Free
Degreaser

DEFOAMERS

5600 Defoamer

Water Maze 5600 is a fast-acting defoamer concentrate that quickly suppresses froth and suds often found in waste streams bound for processing through a waste water evaporation system. Water Maze 5600 can also be used in aqueous-based waste water treatment systems.

1 gal. (8.719-138.0) | 5 gal. (8.719-139.0) | 55 gal. (8.719-140.0)

This product for use in:
• Evaporation

Defoamer A-32

Defoamer A-32 is a water dispersible defoamer/antifoam that is highly effective in controlling foam in waste water evaporators processing metal working fluids. Defoamer A-32 is particularly effective in waste water streams containing semi-synthetic and synthetic metal-working compounds. It can also be used in a wide variety of other aqueous based waste water systems.

5 gal. (8.749-779.0) | 55 gal. (8.749-778.0)

This product for use in:
• Evaporation

ADDITIVES

EC+ Plus Flocculant

Water Maze EC+ PLUS is an anionic flocculant for use with the Water Maze Innovator Series water treatment systems. It is extremely effective in wash water clarification and solids removal. When added continuously, after the water has been treated by electro-coagulation or the Water Maze CoAg+, EC+ PLUS promotes agglomeration of the coagulated suspended solids into larger particles, which are then easily removed from the water by settling and filtration.

5 gal. (8.940-586.0) | 55 gal. (8.725-508.0)

This product for use in:

- Electrocoagulation Systems
- Chemical Coagulation Systems

CoAg+ Coagulant

Water Maze CoAg+ is a proprietary and uniquely formulated coagulant, containing highly reactive polyaluminum chloride and polyamine. The CoAg+ is highly effective at coagulating suspended solids and emulsified oils and greases from a variety of applications. It is cost and performance effective when compared to other metal salts and polymer based treatment programs.

5 gal. (8.725-445.0) | 55 gal. (8.725-446.0)

This product for use in:

- Chemical Coagulation Systems

Metal R+ Coagulant (for Metals Removal)

MetalR+ provides an easy, flexible and cost efficient solution to reduce metal concentration. It is effective against a wide array of metals and removes various co-existing heavy-metals at the same time. The chelating power of the dithiocarbamate group allows the direct precipitation of complexed or chelated metals. Chemically stable sludge is generated avoiding any secondary pollutions. It is extremely cost effective and will remove Cu, Zn, Hg, Pb, Cd, Ag, Ni, Co, Fe⁺², Cr⁺³, Au, Pt and Sn.

5 gal. (8.750-280.0) | 55 gal. (8.750-281.0)

This product for use in:

- Chemical Coagulation Systems

Liquid Alum pH Adjusting Agent (Acidic)

Water Maze Liquid Alum is a 20% liquid aluminum sulfate solution for use as a pH adjust chemical or a coagulant in water treatment. It is ideally suited for use with Water Maze wash water treatment systems but is also suitable for use in a wide variety of waste water treatment systems and applications. Best results are obtained when Water Maze Liquid Alum is injected directly into the waste water stream on a continuous basis.

5 gal. (8.749-550.0) | 55 gal. (8.749-549.0)

This product for use in:

- All Water Treatment Systems

No Rust Corrosion Inhibitor

Water Maze's No Rust concentrated corrosion inhibitor is designed to provide rust protection in Water Maze industrial waste water evaporators. When added continuously this unique blend of chemicals will prevent corrosion to the wetted metal surfaces of a waste water evaporator. Water Maze No Rust also acts as a dispersing agent, which helps prevent deposit build-up in the evaporator tub and facilitates removal of the concentrate at the end of the evaporation cycle. This helps maintain energy efficiency during the evaporation process and adds to the ease of evaporator cleaning and concentrate removal.

5 gal. (8.749-782.0) | 55 gal. (8.749-781.0)

This product for use in:

- Evaporators with carbon steel tanks

OxiMaze+ Oxidizing Agent

A powerful new oxidizer from Water Maze to be used as a sanitizer for very effective odor control within waste water treatment systems. OxiMaze+ is a much safer and more effective alternative to chlorine (sodium hypochlorite). OxiMaze+ is non-toxic, non-corrosive and has a much higher reactivity rate than chlorine. OxiMaze+ also stays in the wastestream much longer than other sanitizers (like ozone gas), making it a very effective treatment, long term. OxiMaze+ kills pathogens in wastestreams, and the required ORP (Oxidation Reduction Potential) level is much less than Chlorine (almost 50% less). Shipped in concentrate form, OxiMaze+ saves shipping costs allowing you to offer a better solution to your customer.

5 gal. (8.750-499.0) | 55 gal. (8.750-500.0)

**Cannot Ship Via UPS.*

This product for use in:

- All Water Treatment Systems

pH ADJUSTERS

pH Plus Powder

Water Maze pH Plus Powder is for use as a pH adjust chemical in water treatment applications to raise the pH when a powder form is preferred. If dissolved in warm water, this 45 LB container will make 15 gallons of a liquid RTU pH adjust product. It is ideally suited for use with Water Maze water treatment systems, but is also suitable for use in a wide variety of waste water treatment applications where the pH needs to be lowered.

45 lb. Container (8.698-045.0)

This product for use in:

- All Water Treatment Systems

pH Plus Liquid

Water Maze pH Plus Liquid is for use as a pH adjust chemical in water treatment applications to raise the pH. It is ideally suited for use with Water Maze water treatment systems, but is also suitable for use in a wide variety of waste water treatment applications where the pH needs to be raised. Best results are obtained when Water Maze pH Plus Liquid is injected directly into the waste water stream on an automatic basis.

5 gal. (8.698-046.0) | 55 gal. (8.698-047.0)

This product for use in:

- All Water Treatment Systems

pH Minus Powder

Water Maze pH Minus Powder is for use as a pH adjust chemical in water treatment applications to lower the pH when a powder form is preferred. If dissolved in warm water, this 45 LB container will make 15 gallons of a liquid RTU pH adjust product. It is ideally suited for use with Water Maze water treatment systems, but is also suitable for use in a wide variety of waste water treatment applications where the pH needs to be lowered.

45 lb. Container (8.698-048.0)

This product for use in:

- All Water Treatment Systems

pH Minus Liquid

Water Maze pH Minus Liquid is for use as a pH adjust chemical in water treatment applications to bring the pH down. It is ideally suited for use with Water Maze water treatment systems, but is also suitable for use in a wide variety of waste water treatment applications where the pH needs to be lowered. Best results are obtained when Water Maze pH Minus Liquid is injected directly into the waste water stream on an automatic basis.

5 gal. (8.698-049.0) | 55 gal. (8.698-050.0)

This product for use in:

- All Water Treatment Systems

OxiMaze pH Balance

Water Maze OxiMaze pH Balance Powder has been formulated for use with the Oximaze+ Oxidizing Agent. This compatible **pH adjuster will lower the pH within a water treatment system.** This powder mix makes 55 gallons of RTU pH adjust product when mixed with warm water.

45 lb. Container (8.698-051.0)

This product for use in:

- All Water Treatment Systems

Additives and Defoamers

- Additives for enhanced effectiveness of water treatment systems
- Defoamers and anti-foam agents for use with HBG and HBE evaporators where waste stream includes oils, soaps, organics, etc.



Description	Part #
5600 Defoamer, 1 gallon	8.719-138.0
5600 Defoamer, 5 gallons	8.719-139.0
5600 Defoamer, 55 gallons	8.719-140.0
Defoamer A-32 (for use with coolants), 5 gallons	8.749-779.0
Defoamer A-32 (for use with coolants), 55 gallons	8.749-778.0
Liquid Alum, 5 gallons (20% concentrate)	8.749-550.0
Liquid Alum, 55 gallons (20% concentrate)	8.749-549.0
EC+Plus, Wash-Water Flocculant, 5 gallons	8.940-586.0
EC+Plus, Wash-Water Flocculant, 55 gallons	8.725-508.0
No Rust, Evaporator Corrosion Inhibitor, 5 gallons	8.749-782.0
No Rust, Evaporator Corrosion Inhibitor, 55 gallons	8.749-781.0
CoAg+, Coagulant, 5 gallons	8.725-445.0
CoAg+, Coagulant, 55 gallons	8.725-446.0
Metal R+, Coagulant, 5 gallons	8.750-280.0
Metal R+, Coagulant, 55 gallons	8.750-281.0
Oxi-Maze, Oxidizer, 5 gallons*	8.750-499.0
Oxi-Maze, Oxidizer, 55 gallons	8.750-500.0

*Cannot Ship Via UPS.

Quick-Release Detergents

- Quick-release for use in conjunction with water treatment systems
- Low-foaming, formulated specifically for use with pressure washers



Description	Part #
Enviro-Clean, Phosphate-Free Detergent, 5 gallons	8.916-591.0
Enviro-Clean, Phosphate-Free Detergent, 55 gallons	8.916-594.0
Enviro-Clean+Plus, Low Phosphate Detergent, 5 gallons	8.916-589.0
Enviro-Clean+Plus, Low Phosphate Detergent, 55 gallons	8.916-592.0
Enviro-Degreaser, Phosphate-Free Detergent, 5 gallons	8.916-590.0
Enviro-Degreaser, Phosphate-Free Detergent, 55 gallons	8.916-593.0
pH Plus, Powder Concentrate, 45 pounds	8.698-045.0
pH Plus, Liquid, 5 gallons	8.698-046.0
pH Plus, Liquid, 55 gallons	8.698-047.0
pH Minus, Powder, 45 pounds	8.698-048.0
pH Minus, Liquid, 5 gallons	8.698-049.0
pH Minus, Liquid, 55 gallons	8.698-050.0
OxiMaze pH Balance, 45 pounds	8.698-051.0

Filter Media

- Virgin coconut shell activated carbon
- Multi-media provides solids separation



Description	Part #
Sand, 20-40 Size, 50 lb Bag	8.718-920.0
Gravel, 50 lb Bag	8.718-921.0
Anthracite #1 .60-.80mm, 50 lb Bag	8.718-922.0
Garnet, 30 x 40, 100 lbs per Bag	8.718-923.0
Garnet, 8 x 12, 100 lbs per Bag	8.718-924.0
Carbon, Virgin Coconut, 8 x 30 55 lb Bag	8.718-933.0

Clay & Filter Paper



8.718-927.0

- For use with waste water flocculation systems
- Specially blended for wide range of applications
- **BC-77 DKG:** Ideal for treating oils, metals, detergents
- **BC-77 KAG:** Ideal for treating oils, metals, detergents and to lower the pH
- **BC-77 JSG:** Ideal for treating recycle water
- **FC-77 ORLG:** Granular blend for use with polymer
- **OC-77:** Organophile blend with anthracite to remove emulsified oils and organics

Description	Part #
Clay, BC-77 DKG (50 lb Bag)	8.718-927.0
Clay, BC-77 KAG (50 lb Bag)	8.718-928.0
Clay, BC-77 JSG (50 lb Bag)	8.718-930.0
Organoclay, OC-77 (50 lb Box)	8.718-931.0
Kärcher Clay RM-847 (44 lbs)	6.295-164.0

Sludge Containment



8.719-191.0

- Biodegradable
- Natural fiber material

Description	Part #
Tub, Sludge, with Lid (Black)	8.906-478.0
Bag, Sludge, Qty 1, Biodegradable	8.719-191.0
Grass Catcher Sludge Containment	8.903-602.0

Bioremediation Consumables



8.718-919.0

8.718-914.0

8.718-915.0

- Exclusive to Waterstax
- Biodegradable
- Store in cool location or refrigerator
- Convenient packaging

Description	Part #
Bio-Puck HC, 4-pack with BioNutrient and 4 pit socks	8.718-913.0
Bio-Puck HC, box of 20 pucks	8.749-853.0
Bio-Puck GT, 4-pack with 4 pit socks	8.718-914.0
Biostax 1800, makes 55 gallons	8.718-918.0
Biostax 100 Hawaiian Blend (8 oz Vial), makes 5 gallons	8.718-917.0
Bio-Nutrient, 8 oz bottle	8.718-916.0
Biostax 1800 (Two 8 oz Vials)	8.718-919.0

Air Valves

- Simple design
- Maintenance free
- Self cleaning

8.749-845.0



Description	Part #
Gemu Silverline, Threaded Ends & 2" Female Tail Piece	8.716-422.0
3 Way Ball Assembly, CLP Automatic	8.749-845.0
Solenoid, Air, Gemu Type 322	8.716-426.0

Alpha Coalescing Parts



8.706-671.0

- Oil-Loving polypropylene grids
- Proprietary maze design for optimum oil-water separation

Description	Part #
Grid, Vertical Coalescing, Large, 20.5" x 32.5"	8.706-666.0
Grid, Mini Coalescing, Small, 17" x 16"	8.706-668.0
Grid, Horizontal Coalescing	8.706-671.0
Suitcase Only For Pom Pom Filters (filters not incl.)	8.706-672.0
Pom Pom, Sorbaid (order 2 per suitcase)	8.706-673.0
Grid, Horizontal Coalescing (Delta 500)	8.706-675.0
Strap, Coalescing Grid, 60"	8.709-338.0
Strap, Coalescing Grid, 112"	8.709-339.0
Strap, 84", Filter	8.709-342.0

WB Blowers & Draft Inducer

- External motor
- Aluminum fan



8.715-192.0

Description	Part #
Draft Inducer D-3, HBG/HBE	8.715-192.0

HBG Burners

- Industrial duty
- Simple operation

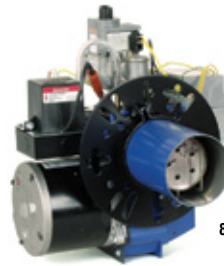

8.717-100.0

Description	Part #
Wayne, P250 AFEP, 115V, HBG-15 NG	8.717-099.0
Wayne, HSG-400, HBG-30	8.717-100.0
Wayne, P250 AFEP, 115V, HBG-15 LPG	8.717-101.0

HBG Burner Parts & Elements

- Industrial applications

Description	Part #
Ignition Module, HBG-15	8.717-990.0
Valve, Gas Burner HBG-15	8.717-991.0
Valve, Gas White Rodgers HBG-30	8.717-992.0
Control, Primary Safety, w/ 30 Sec Pre-Purge HBG-30	8.718-006.0

Exhaust Stacking



8.717-742.0

Description	Part #
Flue Adapter, 6" HBG-15, No Flange	8.717-738.0
Flue Adapter, 10" HBG-30, No Flange	8.717-739.0
Shield, Rain, 6" Flue Pipe, Water Blaze	8.717-740.0
Shield, Rain, 10" Flue Pipe, HBG	8.717-742.0
Shield, Rain, 12" Flue Pipe, WB-120	8.717-743.0

Flow Meters & Gauges

- Simple design
- High impact plastic

8.712-136.0

Description	Part #
Flowmeter 1.5"	8.712-136.0
Pressure, 0-100 1/4" Bottom	8.712-154.0
Pressure, 0-10 PSI	8.712-155.0



Filter Tanks and Elements

- Roto-molded for strength
- Corrosion and UV Resistant
- Self cleaning laterals
- Patented water distribution system



8.723-202.0



8.723-206.0



8.723-217.0

Description	Part #
Media, 3.1 sq ft, CrystalFlo II	8.726-028.0
Media, 4.9 sq ft, Tagelus 100D	8.726-029.0
Filter Tank, 125 sq ft, w/ element, StaRite	8.723-204.0
Filter Tank, 200 sq ft, w/ element, StaRite	8.723-205.0
Filter Tank, 300 sq ft, w/ element, StaRite	8.723-206.0
Cartridge Element , 125 sq ft, StaRite	8.723-215.0
Cartridge Element , 200 sq ft, StaRite	8.723-216.0
Cartridge Element , 300 sq ft, StaRite	8.723-217.0
Element, 200 sq ft, 20 Micron, Jacuzzi*	8.716-840.0
Element, 250 sq ft, 20 Micron, Jacuzzi*	8.716-847.0
Element, 200 sq ft, 5 Micron, Jacuzzi*	8.716-871.0
Element, Filter, 100 sq ft, Jacuzzi*	8.716-872.0

*Limited supply available; contact Customer Service for availability status

ORP/pH Controller Parts



8.716-905.0



8.716-906.0



8.716-990.0

- ORP/pH probes resistant to fouling
- Original replacement parts

Description	Part #
Tubing, 1/4" ID x 7/16" OD, Norprene	8.711-736.0
Fitting, Compression 1/2"	8.716-970.0
Collar VSP-20, for ORP/pH Control	8.716-974.0
Kit, VSP-20 Parts, Suction/ Discharge Kit	8.716-979.0
Tubing, ORP/pH Controllers 15 ft Opaque	8.716-984.0
Injector, I.P.F. ORP/VSP 20 Metering	8.716-986.0
Controller Only, ORP/pH Digital CH250	8.716-990.0
Chlorinator, Model #910	8.709-144.0
pH-only Controller w/ probe, 120V, stand alone	8.716-989.0

Testing Kits

- Top quality
- Simple to use



8.720-010.0

Description	Part #
Chlorine Test Strips	8.720-009.0
pH Test Strips	8.753-577.0
Flowmeter, Ozone	8.712-138.0
EC+Plus Waste water Test Kit	8.749-144.0

Ozone Generators



8.905-715.0

- High output ozone for effective oxidation of bacteria and control of odor
- Ultra-violet ozone generation
- 1-, 2- and 4-bulb configurations

See page 13 for complete Ozone Generator with circulation system

Description	Part #
Series 101 (120V)	8.905-707.0
Series 101 (220V)	8.905-709.0
Series 200 (120V)	8.905-714.0
Series 200 (220V)	8.905-715.0
Series 400 (120V)	8.905-716.0
Series 400 (220V)	8.905-717.0

Above models require power supply and/or circulation system

Ozone Generator Parts

- Direct replacement UV lamps
- CD maintenance kit



8.716-600.0

Description	Part #
Valve, Ozone Meter, 1/4" Plastic	8.707-321.0
Valve, 3/8" Tubing Check, Kynar	8.707-355.0
Injector, Ozone w/o Check Valve	8.709-431.0
Flowmeter, Ozone	8.712-138.0
Ballast, 120V / 220V Ozone Generator	8.716-590.0
Connector, 4 Pin Plug	8.716-592.0
Lamp, Ozone Replacement	8.716-600.0

Scot Pumps & Repair Kits

- Heavy-duty cast iron body
- Stainless steel impeller

8.715-402.0



Description	Part #
1-½ hp 208/230/460V 3PH, 20 GPM/ 50 PSI	8.715-400.0
2 hp 208/230V 1PH, 50 PSI	8.715-402.0
2 hp 208/230/460V 3PH, 32 GPM/ 50 PSI	8.715-404.0
2 hp 115/230V 1PH, Stainless Steel	8.715-357.0
Seal / O-Ring Kit, Filter Pump (Jacuzzi)	8.716-814.0
Kit, Beta Pump Repair (Jacuzzi)	8.716-816.0

Grundfos Pumps & Repair Kits



- Application specific design
- Long lasting

8.716-765.0

Description	Part #
½ hp Sump Stainless Steel, AP-12,120V	8.715-364.0
Kit, Wear Plate (Grundfos Sump Pump)	TBD
Kit, Gasket, Sump Pump	TBD
Shaft Seal, Jet Pump	8.716-765.0
Kit, O-Ring & Gasket, Jet Pump	8.716-766.0
Kit, O-Ring, Vit. G-FOS, #7 Buna, 13, 18, 19	8.716-767.0
Seal, John Crane Type 6, ⅝" Viton/Carbon/Ceramic Seat	8.716-768.0

Pumps & Repair Kits — Jacuzzi Cyclone

Description	Part #
¾ hp 115/230V 1PH, Cyclone	8.715-383.0
½ hp 115/230V 1PH, Cyclone	8.715-382.0
REPAIR KITS	
¾ hp Cyclone, Impeller Kit	8.716-796.0
¾ hp Cyclone, Impeller Only	8.716-793.0
½ hp Cyclone, Impeller Kit	8.716-795.0

Pumps & Repair Kits — StaRite

Description	Part #
2 hp 230V 1PH, StaRite	8.723-198.0
¾ hp 115V 1PH, Ozon	8.917-759.0
¾ hp 230V 1PH, Ozon	8.917-760.0
¾ hp 230V 1PH, With Bakset, StaRite	8.723-175.0
¾ hp 208-230/460V 3PH, Ebara	8.723-219.0
REPAIR KITS	
Shaft Seal Kit (for 8.723-198.0 only)	8.749-351.0
Mech. Seal Ebara (For 8.723-219.0)	8.750-017.0

Little Giant Pumps

- Heavy-duty cast iron



8.715-367.0

Description	Part #
Sump, ½ hp 120V	8.715-367.0
Sump, ½ hp 220V	8.715-369.0
Pump, Submersive 10S-CIM 208-240V (Requires below Part #8.753-542.0)	8.753-541.0
Mech Float Switch 15ft Cord (Requires above Part #8.753-541.0)	8.753-542.0

Ebara Pumps

- Heavy-duty impeller
- Stainless steel



8.715-438.0

Description	Part #
Sump, ½ hp 230V / 3PH	8.715-438.0
Sump, ½ hp 460V / 3PH	8.715-439.0

Peristaltic Metering Pumps

- Roller cam designed
- Hose compression pump



8.749-856.0



8.715-378.0

Description	Part #
VSP20 Metering, 24V	8.715-378.0
VSP20 Metering 120V	8.715-379.0
Pump, Peristaltic, 1-7 GPD	8.749-856.0
Pump, Peristaltic, 8-45 GPD	8.749-855.0
Squeeze Tube	8.750-963.0

ARO Pump

- Heavy-duty air diaphragm
- Corrosion resistant



8.715-278.0

Description	Part #
Air Diaphragm, ½" Polypropylene	8.715-278.0
Air Diaphragm, ½" Stainless Steel	8.715-279.0

Regulators

- Preset and adjustable available
- Heavy-duty

8.716-420.0



Description	Part #
Regulator, Pressure w/ Gauge	8.716-420.0
Filter, Coalescing	8.716-421.0
Regulator, Rockwell 3/4" 143-80 WB	8.717-748.0

Tanks & Pressure Tanks

- Internal bladder
- Compact design

8.719-176.0



Description	Part #
Pre-pressurized, 4.4 gal	8.719-176.0
Pressurized, 20 gal	8.719-178.0

HBG / HBE Tanks / Combustion Box

- Cast in place fiberfrax insulation

CAUTION: Double check operators manual to verify part number for sparger tube as they vary with different models



8.913-198.0

Description	Part #
Insulation, 1" x 2" HBG, /ft	8.717-434.0
Tank, HBG-15/99, Steel	8.913-195.0
Tank, HBG-15, 316L Stainless Steel	8.913-196.0
Tank, HBG-15/99, AL-6XN	8.913-197.0
Tank, HBG 30, Mild Steel	8.913-223.0
Tank, HBG 30, AL-6XN	8.913-225.0
Firebox, HBG-15	8.913-198.0
Firebox, Insulation, HBG-30	8.913-236.0

Water Blaster Unloader

- Preset and adjustable available
- Heavy-duty



Description	Part #
Unloader	8.715-513.0

Alarm

- 90 decibel
- Piezo design



Description	Part #
Alarm, 24V AC, Panel Mount	8.716-266.0

Electrical Switches



9.802-451.0

- Waterproof
- Soft rubber feel
- Various designs

Description	Part #
Rocker, Carling w/ Green Lens	9.802-451.0
Curvette, HBG 2-position	9.802-453.0
Curvette, 2-position Wide Switch	8.716-051.0
Curvette On-Off-On, HBG 3-position	8.716-052.0
Momentary Push, small	8.716-091.0
Micro Switch, Roller Lever	8.716-630.0
Block, Contact, N/C, CH E22B1	9.802-534.0
Block, Contact, N/O, CH E22B2	9.802-535.0
2-pos, CH E22Vb51, Carling w/ Light	8.716-718.0
Switch/ Gauge, Capsu-Photohelic Press, 0-10"	8.718-200.0

Float Switches



8.716-142.0



8.716-632.0

- Corrosion resistant for long life
- Adjustable tethered floats

Description	Part #
Float, N/O Tethered (Black)	8.716-142.0
Float, N/C Tethered (Gray)	8.716-143.0
Liquid Level, M-5000 HBE/HBG	8.716-294.0
Liquid Level, LS1800, Alpha	8.716-632.0
Sensor, Capacitance, 3-point, WB	8.716-300.0

Fuses

- Various sizes
- Industry standard design

Code	Max Voltage	Amps	Part #
FNM1/2	250V	0.5	9.802-463.0
FNM1	250V	1.0	8.716-173.0
FNM2-1/2	250V	2.5	9.803-977.0
FNM7	250V	7.0	8.716-194.0
FNM8	250V	8.0	9.802-460.0
<hr/>			
FNQ-R-3	600V	3.0	9.802-465.0
<hr/>			
KTK-R2	120V	2.0	9.803-663.0
KTK-R4	600V	4.0	8.716-180.0
KTK-R5	600V	5.0	9.804-050.0
<hr/>			
MDL1/2	120V	0.5	8.716-170.0
MDL2-1/2	24V	2.5	8.716-174.0

High Temp Cut-Out Switch

- High temperature rated



8.712-175.0

Description	Part #
Switch, Manual Reset, 220°F WB	8.712-172.0
Hi Limit Control, 700°F, HBG (Mild Steel Tank)	8.712-174.0
Thermocouple, SS Sheath, 34" Long, Type K, HBG	8.712-175.0
Hi Limit Control, 900°F, HBG (SS Tank)	8.712-176.0

Indicator Lights

- Long lasting
- High intensity bulb



8.716-095.0

Voltage	Color	Part #
125V	Red	8.716-095.0
125V	Green	9.802-455.0
125V	Amber	8.716-408.0
125V	Blue	8.716-409.0
28V	Blue	9.803-650.0
28V	Green	9.803-652.0

Pressure Switches



8.716-413.0

- Adjustable set point
- Stainless steel body
- Diaphragm design

Description	Part #
Square D, N/C Use w/ 2-10893, 2-1072	8.716-154.0
PM11120A-1PF, 1 PSI	8.716-156.0
PM11160X-15PR, 15 PSI	8.716-158.0
Barksdale, Air Proving	8.716-413.0

Relays



9.802-466.0



9.802-468.0

- Din rail mountable

Description	Part #
Relay Socket, SH3B05*IDEC	8.752-146.0
Relay, 120V, RH2B-UL-AC120	9.802-468.0
Relay Latch 2, RH2LBUAC120*IDEC	8.752-141.0
Relay, Power Omron G4B112T1FDCUSRPAAC120	8.716-235.0
Relay, Sky Mfg. 120V # SKHT-1X	8.716-264.0
Base, Relay, SH2B-05, IDEC	9.802-467.0

Solenoids

- Preset and adjustable available
- Heavy-duty
- Diaphragm seat
- Corrosion resistant

8.716-697.0



Description	Part #
Coil, 120V, Water Side	8.716-689.0
Valve, Parker, Water Side	8.716-690.0
Valve, Parker, Air Side	8.716-691.0
Solenoid Coil, 120V, Air Side	9.802-533.0
Solenoid, Water Maze, PVC 24V Rainbird	8.716-697.0
Solenoid, Valve 120V, Hit 310-100-1	8.716-700.0

Timers



8.716-237.0

- Various designs
- User friendly

Description	Part #
Hour Meter, 115VAC 60hz	9.802-283.0
Timer, Red Lion	8.716-236.0
Counter, Red Lion	8.716-237.0
Timer, Variable Time	8.716-251.0
Base, Timer IDEC Socket	8.716-252.0
Timer, 24 Hour Pin, 120V 20A	8.716-253.0
Controller, Automatic Maint, CLP-7034	8.716-438.0

Transformers



9.802-550.0

- Heavy-duty fuse protected

Primary Voltage	Secondary Voltage	Size	Part #
208/120	.500KvA	50/60 Hz	8.716-873.0
240/480V	120/240V	.500KvA	9.802-550.0
240/480V	120V	.050KvA	9.802-551.0
120/240V	24V	.050KvA	9.802-553.0
550V/575/600V	115V	.050KvA	9.803-668.0
120/240V	24V	.100KvA	8.716-904.0
120/24V/30VA HBG-15			8.717-985.0
Ignition 612-6A020E 120V WB			8.718-177.0

Ball Valves

- PVC Sch 80
- Heavy-duty

8.707-361.0



Description	Part #
1" Slip x Slip	8.707-359.0
1-1/2" Slip x Slip	8.707-361.0
1-1/2" FPT x FPT Molded	8.707-362.0

Brass Parts

- Precision threads
- Long lasting



9.803-557.0

9.802-152.0

Description	Part #
Nipple, 1/4" Close	8.706-777.0
Nipple, 1/4" Hex	8.706-780.0
Nipple, 1/2" JIC x 1/2" MPT Pipe	9.802-128.0
Nipple, 3/4" JIC x 3/4" Pipe	8.706-899.0
Elbow, 1/2" JIC x 1/2", 90°	9.802-131.0
Elbow, 3/4" SAE x 3/4", 90°	9.803-557.0
Hose Barb, 1/4" Barb x 1/4" Pipe, 90°	8.706-958.0
Swivel, 1/2" MPT x 3/4" GHF w/ Strainer	9.802-146.0
Swivel, 3/4" SAE Fem, Push-On	9.802-152.0

Check Valves

- PVC Sch 80
- Floating ball design

8.707-297.0



Description	Part #
1-1/2" Ball, PVC, Slip x Slip	8.707-297.0
1" Ball, PVC, Slip x Slip	8.707-300.0
1/2" Ball, PVC, FPT x FPT	8.707-298.0
1-1/2" Swing, PVC, Slip x Slip	8.707-299.0
2" Swing, Brass, FPT x FPT	8.707-239.0
3/8" Tubing, Checkvalve	8.707-355.0
1/4" NPT, FPT x FPT	8.707-356.0

Push-On Hose

- Nylon braided
- Heavy wall
- UV protected



9.802-261.0

Description	Part #
1/4", Push-On, Fuel Line, /ft	9.802-254.0
1/2", Push-On, /ft	9.802-259.0
3/4", Push-On, /ft	9.802-261.0

PVC Adapters

- Heavy-duty schedule 80



8.706-441.0

Description	Part #
1" MPT x Slip	8.706-409.0
1-1/2" Slip x MPT	8.706-441.0
1-1/4" Slip x MPT	8.706-442.0
Female, 1" Slip x FPT	8.706-444.0
Female, 1-1/4" Slip x FPT	8.706-445.0
2" Slip x MPT	8.706-451.0

PVC Bulkheads

- Easy to install
- Adjustable seal tite design



8.706-486.0

Description	Part #
2" NPT, Polypropylene	8.706-479.0
3" FPT x FPT	8.706-480.0
1/2"	9.802-051.0
3" FT x FT, Polypropylene	8.706-483.0
1", Polypropylene	8.706-484.0
1-1/2" FPT x FPT, 872-015	8.706-486.0
1-1/2", Polypropylene	8.706-490.0
3/4", Polypropylene	9.802-052.0
Strain Relief, Straight, Liquid Tite	9.802-515.0

PVC Bushings

- Heavy-duty schedule 80



8.706-416.0

Description	Part #
2" x 1-1/2" MPT x FPT	8.706-403.0
1-1/2" x 1" MPT x FPT	8.706-404.0
1-1/4" x 1" MPT x FPT	8.706-405.0
1/2" x 1/4" MPT x FPT	8.706-407.0
1" x 3/4" MPT x FPT, "Speers"	8.706-412.0
1-1/2" MPT x 1-1/4" FPT	8.706-415.0
2" MPT x 3/4" FPT	8.706-416.0

