

IB 10/15 L2P ADVANCED

The IB 10/15 L2P Advanced is the latest generation of dry ice blasters with integrated dry ice production. High cleaning performance, ideal for industrial applications.



Order no.

1.574-201.0

- With integrated heat exchanger for even more efficient dry ice production
- Including pressure regulator and compressed air filter

Technical data

EAN code		4066529028891
Connected load	kW	1
Compressed air connection		1/4" quick coupling
Casing / frame		Plastic rotation body
Certified (by) to		CE
Cable length	m	5.5
Air pressure	bar / MPa	0.7 - 10 / 0.07 - 1
Air quality		Dry & oil-free
Air flow	m³/min	0.07 - 1.5
Dry ice pellets (diameter)	mm	2.5
Dry ice consumption	kg/h	2 - 15
Liquid CO ₂ consumption	kg/h	20 - 60
Number of current phases	Ph	1
Frequency	Hz	50 - 60
Voltage	V	220 - 230
Weight without accessories	kg	84
Weight (with accessories)	kg	84
Dimensions (L × W × H)	mm	898 × 565 × 935

Equipment

Flat jet nozzle	■
Flat jet nozzle, short	■
Spray hose with electrical control cable and quick coupling	■
Jet gun (ergonomic and safe)	■
"Air only" or "Air and ice" switch on the trigger gun	■
Electronic control system	■
Oil and water separator	■

■ Included in the scope of supply.

Users must receive training on this device.



Integrated heat exchanger

- Liquid CO₂ is cooled down. This increases the efficiency of dry ice production by approx. 50%.

Ergonomic blasting gun

- Quick and easy nozzle change thanks to quick-release couplings.
- With integrated lighting.
- Ice on/off switch directly on the trigger gun.

Easy and intuitive operation

- Jet pressure, operating hours, service time shown on the display.
- Dry-ice quantity can be adjusted with a button.
- Integrated status display and assistance systems, e.g. for pressure monitoring.

ACCESSORIES FOR IB 10/15 L2P ADVANCED

1.574-201.0

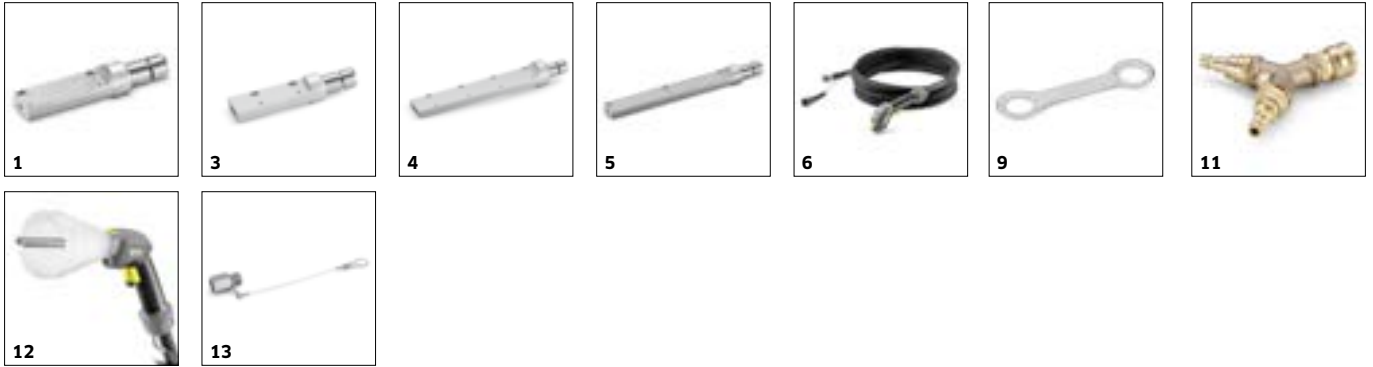

		Order no.	Description	
COMPACT CLASS				
Blast nozzles				
Flat jet nozzle short, power, dia. 3 mm	1	4.574-117.0	Perfect for abrasive applications in hard-to-reach places, short power flat jet nozzle for use with dry ice cleaning systems from Kärcher. With quick-change system.	■
Flat jet nozzle, long, dia. 4 mm	2	4.574-122.0	Long, sturdy, rotatable power flat jet nozzle for use with dry ice cleaners from Kärcher. Features quick-change system and is also particularly well-suited to abrasive applications.	■
Flat jet nozzle short, standard, dia. 3 mm	3	4.574-094.0	Short flat jet nozzle for dry ice cleaning systems from Kärcher. Perfect for gently cleaning delicate surfaces and hard-to-reach areas. With quick-change system.	□
Long flat jet nozzle, dia. 3 mm	4	4.574-083.0	Long, sturdy, rotatable power flat jet nozzle for use with dry ice cleaners from Kärcher. Features quick-change system and is also particularly well-suited to abrasive applications.	□
Round spray nozzle, long, dia. 3 mm	5	4.574-105.0	Long power round jet nozzle for dry ice cleaning systems from Kärcher. For abrasive applications, such as removing stubborn encrustations, paint, oil or soot. With quick-change system.	□
Blasting gun				
Hand trigger gun	6	4.574-067.0	Ergonomic and compact jet gun for Ice Blaster dry-ice blasting system from Kärcher. Includes 5-m spray hose, nozzle light and nozzle quick-change system.	■
Spray hose extension, 5 m	7	4.574-111.0	Extension hose for L2P dry ice blasters from Kärcher. This simple spray hose extension is a straightforward, effortless way to extend the working range of the ice blaster.	□
Attachment sets and other accessories				
Pressure reducer attachment kit, 1/2 inch	8	2.574-009.0	For mounting on the Home Base of our dry ice blasters with L2P technology: attachment kit with pressure reducer, water separator and oil separator. Jet pressure adjusts on the machine as required.	■
Ring spanner wrench SW30 / SW32	9	6.574-337.0	Ring spanner round 2-in-1 function. Suitable for loosening the CO ₂ cylinder lid and for fastening the CO ₂ hose to the cylinder.	■
Holder for CO ₂ cylinder cap	10	2.574-002.0	Practical holder for holding the lids of CO ₂ cylinders during cleaning work with dry-ice blasting system in the Liquid-to-Pellet process, secures against loss.	□
Y-fitting, compressed air	11	2.574-003.0	Special Y-fitting for connecting 2 compressed air hoses with small cross-section to dry ice blasters.	□
L2P Splash Guard	12	2.574-004.0	Adjustable splash guard for cleaning work with dry-ice blasting systems in the Liquid-to-Pellet process.	□
RPV adapter	13	2.574-006.0	To increase the cleaning performance with dry-ice blasting systems: Special adapter for opening the residual pressure valve (RPV) of CO ₂ cylinders.	□
CO ₂ supply line extension, 5 m	14	4.574-144.0	Extension hose with a length of 5 m for connecting CO ₂ cylinders or cylinder bundles to dry ice blasters with integrated dry ice production (liquid-to-pellet/L2P).	□

■ Included in the scope of supply. □ Available accessories.

ACCESSORIES FOR IB 10/15 L2P ADVANCED 1.574-201.0

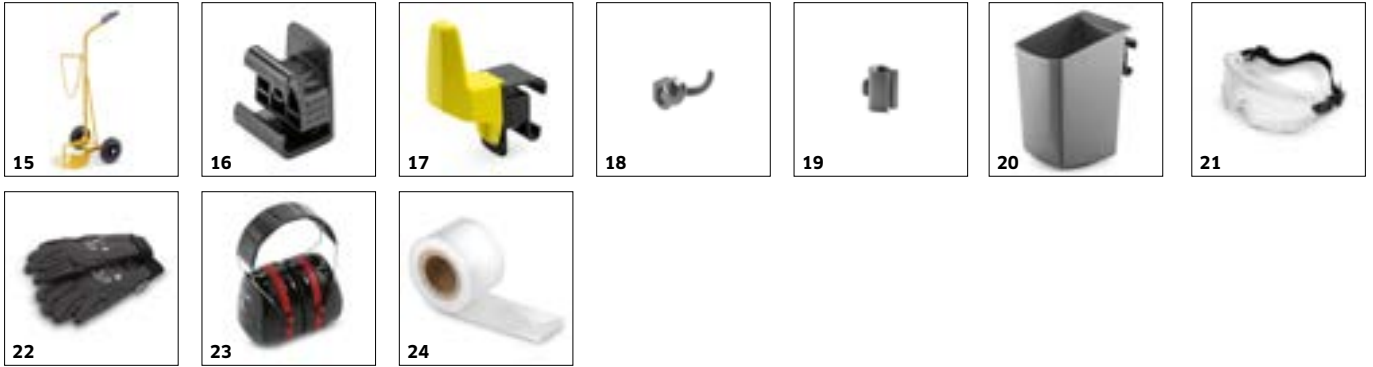

		Order no.	Description	
COMPACT CLASS				
Attachment sets and other accessories				
Cylinder trolley	15	6.574-336.0	Perfect as supplement to the dry-ice blasting systems with Liquid-to-Pellet process: Cylinder trolley for the safe transport of standard CO ₂ cylinder.	<input type="checkbox"/>
OTHER ACCESSORIES SCRUBBER DRIERS				
Home Base accessories				
Home Base adapter	16	5.035-488.0	Fastener for various hooks and clips on the machine.	<input type="checkbox"/>
Universal hook kit	17	4.070-075.0	Hook and adaptor kit for attachment to the Home Base rail scrubber drier by Kärcher. Ideal for space-saving storage of hoses (for example, spray suction attachment kit) on the machine.	<input type="checkbox"/>
Double hook	18	6.980-077.0	Double hook for attaching rubbish bags, etc. to the machine. Only for use with the Homebase adapter 5.035-488.0.	<input type="checkbox"/>
Holder handhold grey	19	6.980-078.0	Mop clip for attaching a mop to the machine. Only for use with the Homebase adapter 5.035-488.0.	<input type="checkbox"/>
SPRAY EXTRACTION MACHINES				
Other				
Cleaning agent container, complete	20	4.070-006.0	Kit consisting of cleaning agent container and Home Base adapter. For connecting Home Base rail.	<input type="checkbox"/>
DRY ICE CLEANING				
Protective equipment				
Safety glasses	21	6.321-208.0	Safety goggles.	<input type="checkbox"/>
Protective gloves	22	6.321-210.0	Cold protection glove, size 10 with slip-resistant profile (Category 3 according to EN 511, Level 12X EN 388, Level 2121).	<input type="checkbox"/>
Hearing protection	23	6.321-207.0	Effective hearing protection with an average insulation rating of 35 dB(A) according to SNR (Single Number Rating).	<input type="checkbox"/>
Mounting kits and other accessories				
Protective foil for IB spray hose, 100 m	24	6.667-214.0	100m-role of tube foil. To protect the blasting hose against dirt as well as against damage.	<input type="checkbox"/>

■ Included in the scope of supply. □ Available accessories.